

Portable Thermal Printer

User Manual

About the button using:

- ◆ Long press "Power" button for two seconds to turn on/off.
- ◆ in power on status, quick press the "Power" button two times to enter the setting.
- ◆ in setting, "power" button for next item, "Feed" button for switch option.
- ◆ Long press the "Power" button for two seconds to quit the setting.
- ◆ Please restart the printer after setting.

Please scan QR code to download CD Files

Download Link:

<http://www.barcoderead.net/printer/8003.zip>



Parts List

Standard Accessories:

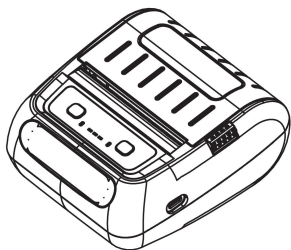

Printer

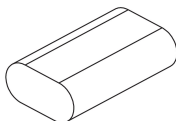

Battery*1 pc



USB Cable*1 pc

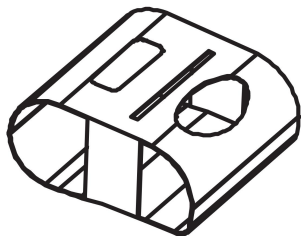

leather Case*1 pc

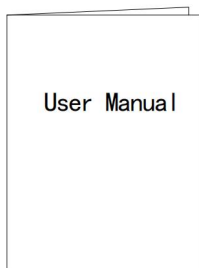

User Manual

Cable User Manual*1 pc

Appearance and Components

front view

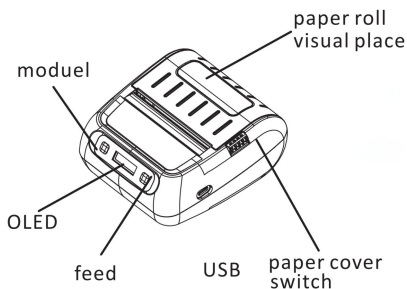

rear view

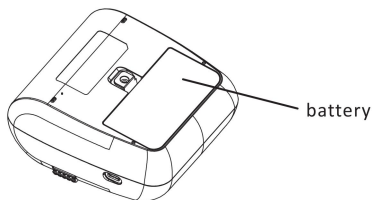

cover open

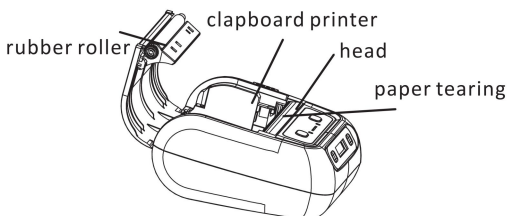

Paper Roll Install

1. Press the paper roll switch, then open the cover.

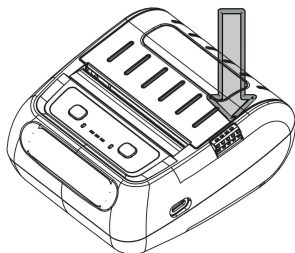

2. Put the paper roll as below picture.

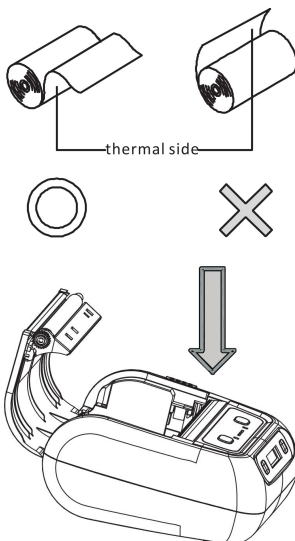

Install the Battery

When the battery is power out, the OLED will be flashing, if continue printing, the printer will be power off automatic and charge the printer in time so that it could continue printing.

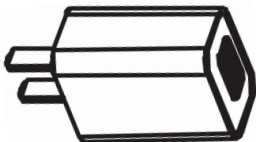
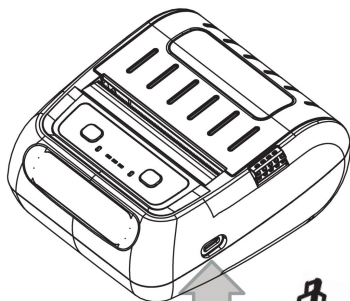

Menu Setting

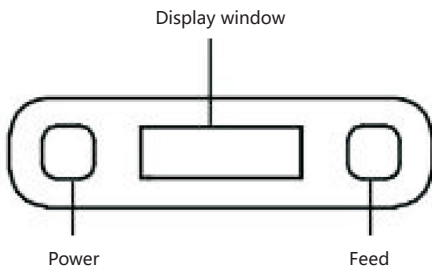

1. Long press **【Power】** the power on or the power off.

2. double click **[Power]** get in setting.

model: language, darkness, Bluetooth, usb, paper type, selfpage print.

3. click **[feed]** change the sub-options.

① Long press **【Power】** the power on or the power off.

② double click **[Power]** change printer model.

Label Editing Software with Android System via Bluetooth Connection

1. Turn on the power of printer.
2. Turn on the bluetooth, find the POS-8003 and type the pin "0000"

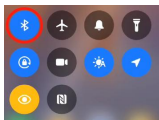

3. Open the label editing software App, please scan below QR code to download the APP.



4Barcode

Android editing software
Install Password:1234

4. Click the printer symbol.
5. Choose the "Bluetooth Connection".
6. Choose the "POS-8003".

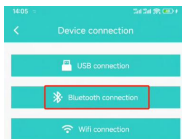
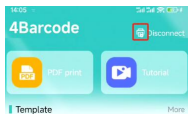

All equipment

POS-8003-D628

7. Connection Successful.

Connected successfully

Label Editing Software with IOS via Bluetooth Connection

1. Turn on the power of printer.
2. Turn on the bluetooth.



3. Open the label editing software App, please scan below QR code to download the APP.



4Barcode

IOS editing software
Install Password:1234

4. Click the printer symbol.
5. Choose the "POS-8003".

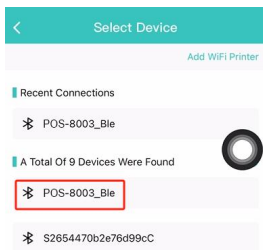
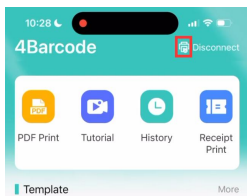

6. Bluetooth connect successful.

Bluetooth Connection Successful