

WRS15T

Pantograph Reach Stacker



INTRODUCTION

Pantograph Reach Stacker is a comfortable and high secure Electric pantograph reach stacker with 1500kg loading capacity, lifting height up to 6m, solution for tight work areas.

INNOVATIONS

- ◆ Moon walk function
- ◆ Turtle speed function
- ◆ Safety speed control- traveling speed automatically declines when forks are lifted to over 500mm, to avoid misoperation and ensure better safety.

PANTOGRAPH REACH STACKER



◆ Handle

Longer handle design.
Wider operation area applied.
Less effort press down handle.



- ◆ Scissor reach and retract.
- ◆ Adjustable forged forks, suited to any type of pallet truck, similar to a traditional forklift.
- ◆ Tilting fork carriage for efficient load placement operations.
- ◆ Side shift allows the load carried to be moved to the left and the right, especially for small space. Cargo can be accurately placed on the shelf.



- ◆ The innovative AC drive system offers strong power, accurate control, excellent performance.
- ◆ High strength ZF (German) gearbox with long working life.
- ◆ Hydr-App (Italy) Hydraulic pump system.
- ◆ Low noise but durable hydraulic unit, good quality cylinder as well as hose ensure high reliability of hydraulic system.



- ◆ Larger front wheels, easier to roll over uneven grounds.



- ◆ **Optional foldable platform**
The ergonomically designed foldable platform makes operations faster and safer.

SPECIFICATIONS

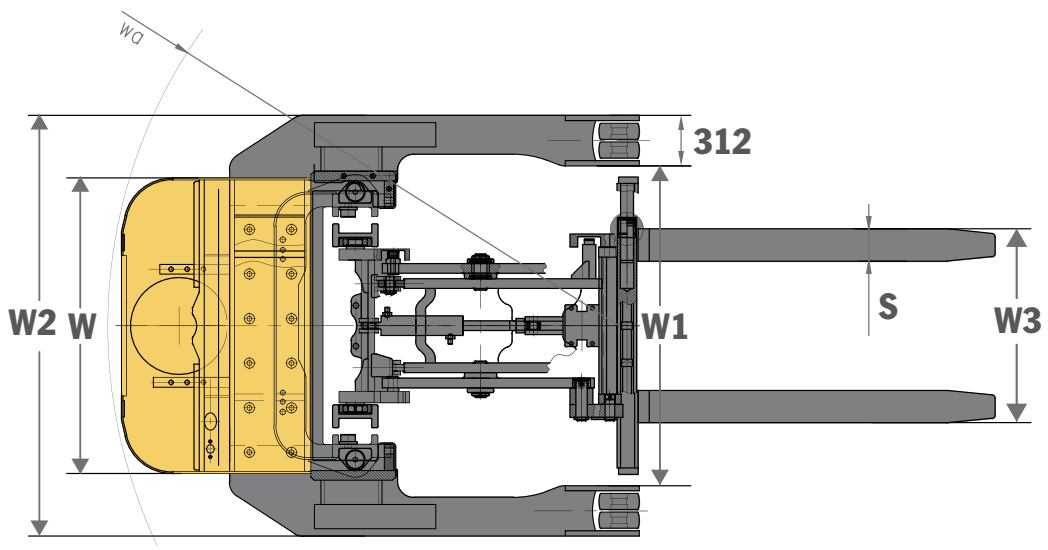
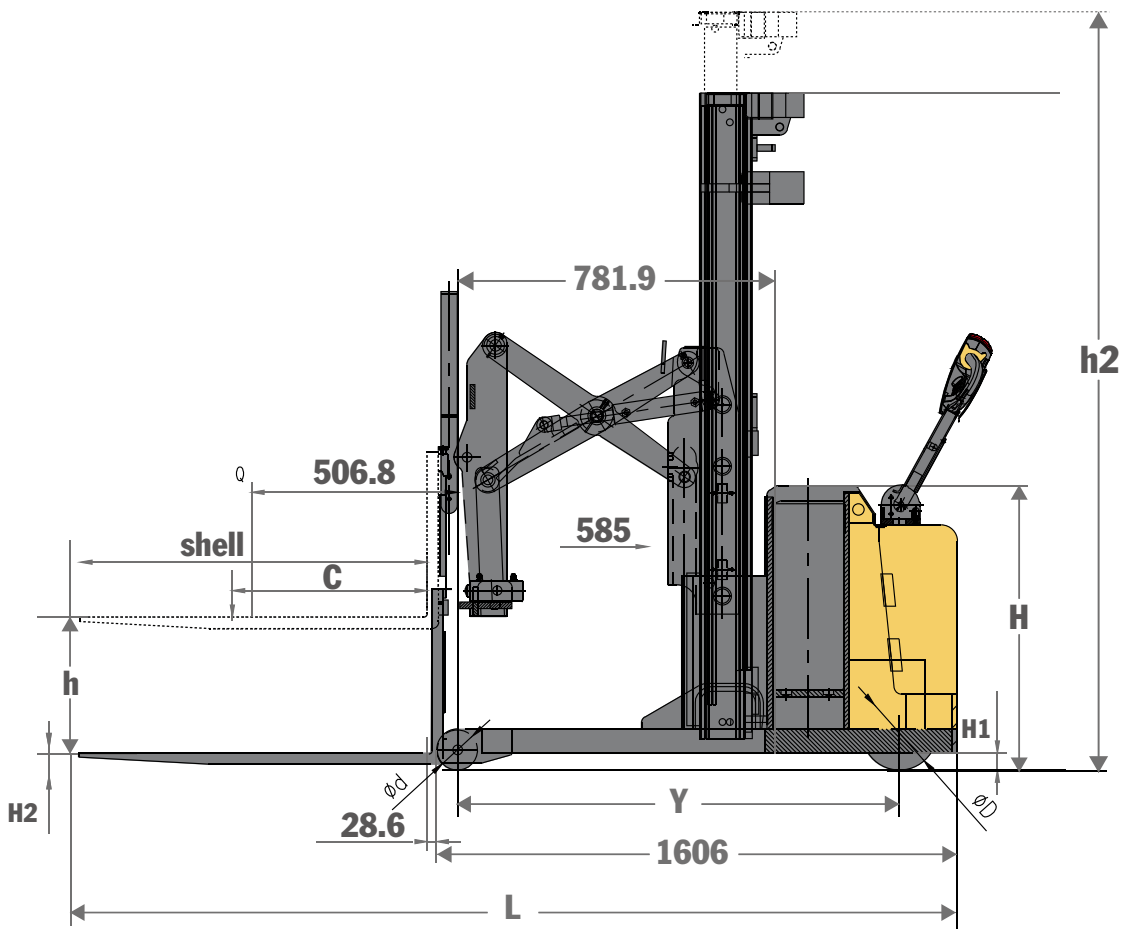

SPECIFICATIONS

MODEL		WRS15T									
CHARACTERISTICS											
1.1	Driving type	Vertical									
1.2	Operate type	Walkie									
1.3	Capacity	Q	kg	1500							
1.4	Load Center	C	mm	600							
1.5	Wheel base	Y	mm	1362							
WEIGHT											
2.1	Weight without battery	kg	2110	2150	2190	2214	2230	2270	2310	2330	
2.2	Weight with battery	kg	2320	2360	2400	2424	2440	2480	2520	2540	
WHEEL											
3.1	Wheel	PU									
3.2	Front wheel	Φd	mm	φ124							
3.3	Driving wheel	ΦD	mm	φ230							
SPECIFICATIONS											
4.1	Mast lifting height	h	mm	3700	4000	4500	4800	5000	5500	5800	6000
4.2	Mast lower height	h1	mm	1820	1920	2087	2187	2254	2421	2521	2570
4.3	Mast extend height	h2	mm	4750	5055	5555	5855	6055	6555	6855	7055
4.4	Overall length(fork forward)	L	mm	2705							
4.5	Overall length(fork backward)			2120							
4.6	Rear body width	W	mm	990							
4.7	Straddle ID	W1	mm	990/1220							
4.8	Straddle OD	W2	mm	1302/1532							
4.9	Fork length	stell	mm	1070							
4.10	Single Fork width	S	mm	100							
4.11	Overall fork width	W3	mm	200~800							
4.12	Side shifting distance	S1	mm	±80							
4.13	Min. fork height	H2	mm	70							
4.14	Freelifting height		mm	1273	1373	1540	1640	1707	1874	1974	2041
4.15	Clearance	H1	mm	52							
4.16	Turning radius(not included the handle)	Wa	mm	1585							
4.17	Rear body height	H	mm	876							
4.18	Aisle width(800*1200mm pallet)horizontal/vertical	Ast	mm	3135							
4.19	Aisle width(1000*1200mm pallet)horizontal/vertical	Ast	mm	3170							
PERFORMANCE											
5.1	Driving speed,Laden/unladen	Km/h	4/4.3								
5.2	Lifting speed,Laden/unladen	mm/s	120/185								
5.3	Lowering speed,Laden/unladen.	mm/s	313/145								
5.4	Gradeability,Laden/unladen.	mm/s	8/10								
ELECTRIC ENGINE											
6.1	Driving motor	kW	2.2								
6.2	Lifitng motor	kW	4								
6.3	Battery	V/Ah	24v / 270Ah								
6.4	battery size	mm	790x210x576								
6.5	Brake		Electromagnetic								
6.6	Controller		1298 Curtis								

LOAD CHART

