



TECHNICAL SPECIFICATION

DRWJ-1.5 UNDERGROUND Load Haul Dump(LHD) Loaders



DRWJ-1.5 Undergroud Diesel LHD Loader is a diesel-powered load-haul-dump machine with a payload capacity of up to 3 tons, making it especially suitable for small-scale underground mining operations. Its compact design overcomes the spatial constraints of narrow mine tunnels.

Main Technical Parameters of the Complete Machine

| No. | Parameter Description | Value |
|-----|-----------------------------------|-------|
| 1 | Bucket Capacity (m ³) | 1.5 |
| 2 | Rated Payload (kg) | 3,000 |

| | | | |
|----|------------------------------------|----------------|-------|
| 3 | Operating Weight, Empty (kg) | 11,400 | |
| 4 | Max. Digging Force (kN) | ≥ 72 | |
| 5 | Max. Dump Height (mm) | ≥ 86 | |
| 6 | Transport Dimensions (L×W×H) (mm) | 7087×1720×2050 | |
| 7 | Min. Ground Clearance (mm) | 218 | |
| 8 | Max. Dump Clearance Height (mm) | 1,510 | |
| 9 | Max. Dump Height (mm) | 1,157 | |
| 10 | Min. Dump Reach (mm) | 740 | |
| 11 | Steering Angle (°) | 38 | |
| 12 | Dump Angle (°) | 38 | |
| 13 | Departure Angle (°) | ≥ 14 | |
| 14 | Frame Oscillation Angle (°) | ± 8 | |
| 15 | Max. Gradability (Loaded) (°) | ≥ 14 | |
| 16 | Min. Turning Radius (Outside) (mm) | 4,817 | |
| 17 | Min. Turning Radius (Inside) (mm) | 2,703 | |
| 18 | Travel Speed(km/h) | 1gear | 6.15 |
| | | 2gear | 10.15 |
| | | 3gear | 22.62 |

Front View

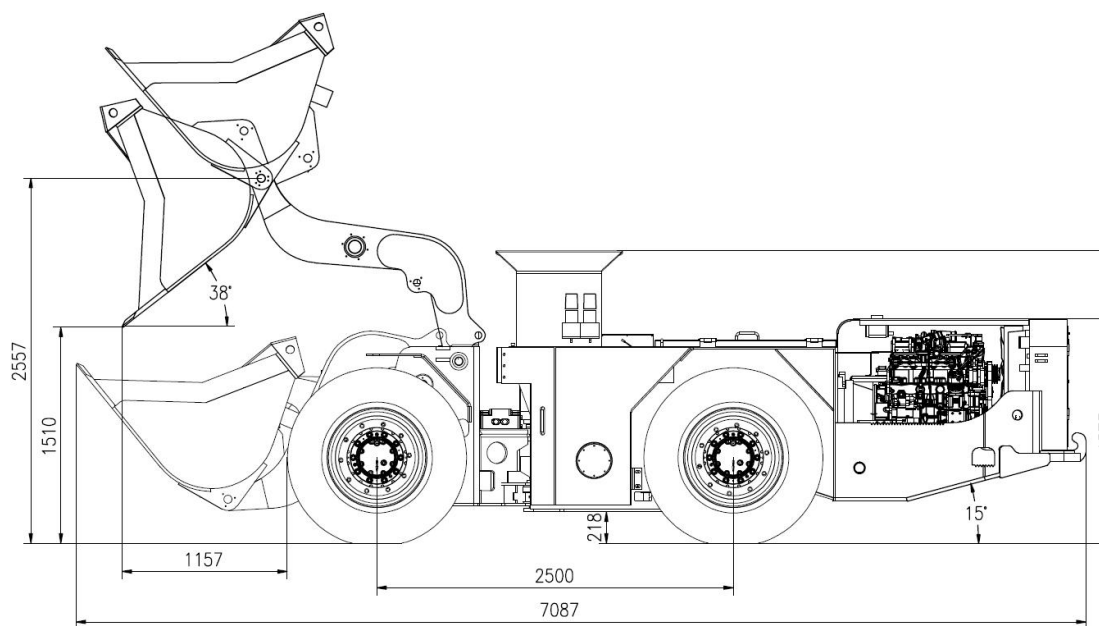

Steering View

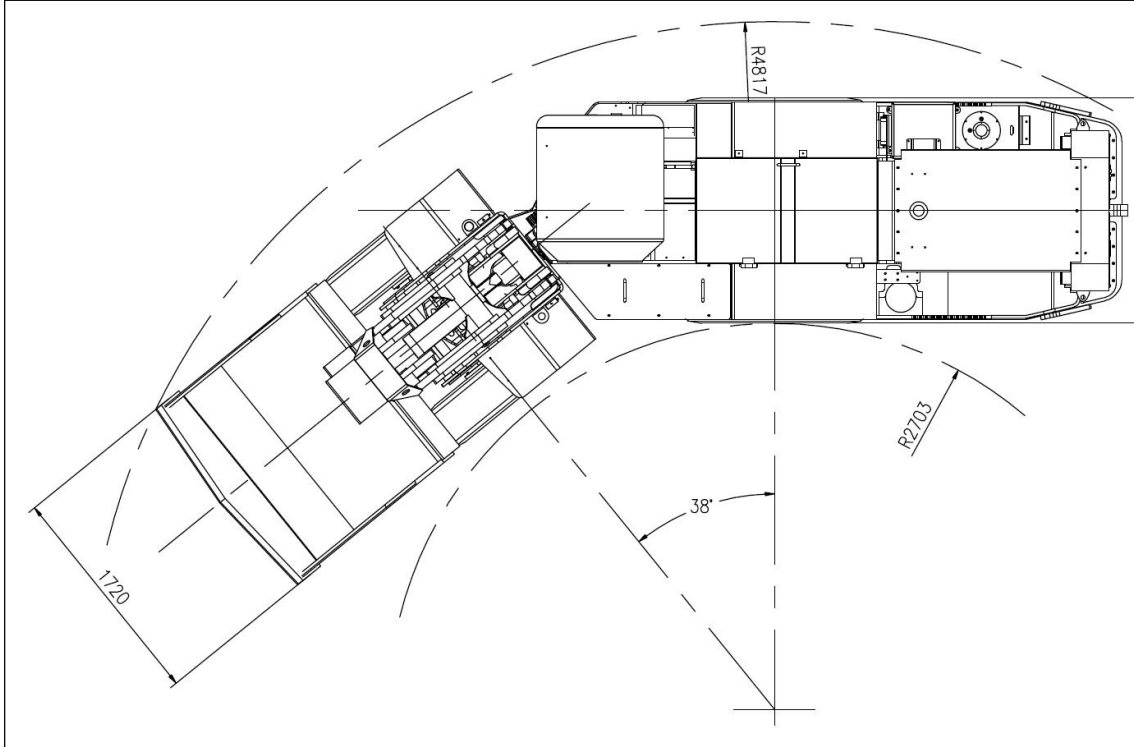

Main Benefits

Low Failure Rate

- Incorporates a Sauer (USA) hydraulic system characterized by low failure rates and optimal engine compatibility, maximizing overall engine efficiency.
- Technological innovation enables the direct series connection of gear pumps and variable displacement pumps, reducing the incidence of faults and extending the service life of gear pumps.
- Key components, including the axle housing, differential, planetary gears, and half-shafts, are designed with enhanced structural optimization and material reinforcement for robustness, durability, high impact resistance, and reduced failure rates.

Durability

- Specially treated hydraulic tanks provide reliable protection for the service life of the vehicle's core components, including pumps and motors. The use of high-quality related parts extends the overall product lifespan.
- All copper bushings of the machine are made of high-strength brass, radially embedded with orderly arranged cylindrical graphite fillers as friction material. This offers advantages such as high precision, strong load-bearing capacity, and excellent wear resistance



| Engine | |
|----------------|------------------------|
| Brand/Model | Yuchai YC4A125-T300 |
| Rated Power | 92kW |
| Cooling Method | Water cooling |

| Hydraulic System | Brand | |
|---------------------------|--------|---|
| Working Pump(Gear Pump) | Wanye | √ |
| Steering Pump(Gear Pump) | Wanye | √ |
| Multi - way Control Valve | Youli | √ |
| Steering Control Valve | Youli | √ |
| Make - up Valve | Miyaco | √ |
| Pedal - operated Valve | Miyaco | √ |

| Transmission | |
|--|---|
| Travel Pump | √ |
| Travel Motor | √ |
| Transfer Case | √ |
| Drive Axle | √ |
| Tube tyres design for underground mine service | √ |

| Electric system | |
|--|---|
| Working Voltage,24V | √ |
| 4.3-inch Color Display Screen | √ |
| Real-time Monitoring of Operating Status of Main System Components | √ |
| CAN Bus Communication | √ |

| Fuel | Litres |
|---------------------------|--------|
| Fuel tank capacity | 141 |
| Travel Hydraulic Oil Tank | 191 |

| Main frame | |
|---|---|
| KA requirement | √ |
| Center hinge and boom up lock device | √ |
| Knockdown construction | √ |
| Handheld fire extinguisher | √ |
| Dump cylinder rod protector | √ |
| Checkfire automatically activated fire suppression system | √ |
| Scooptram Radio Remote Control | √ |
| Tool box | √ |
| Dry-Type Three-Way Catalytic Converter | √ |

| Control system | |
|-------------------------------------|---|
| Engine date display | √ |
| Audio-visual reverse alarm | √ |
| Yellow strobe light-power on | √ |
| Dual-Lever Control | √ |
| Single level dump and hoist control | √ |

| Optional Configurations |
|-----------------------------------|
| Automatic Fire Suppression System |
| Radio remote control |
| Harmful Gas Monitoring |
| Warning Light / Back-up Buzzer |
| 360° Surround View |
| Central manual lubrication |

| Operator's compartment | |
|--|---|
| Canopy(ISO ROPS and FOPS approved) | √ |
| Side seated operator for bi-directional operation and maximum visibility | √ |
| Two-Point Seat Belt | √ |

| Documentation | |
|--------------------------------|---|
| Parts manual | √ |
| Operational manual | √ |
| Maintenance and service manual | √ |