

KL60 Density Meter



Description

KL 60 Density Meters are used to monitor SF₆ gas density in sealed tanks. They are applied to indicate gas density. They are designed to monitor Medium Voltage systems.



KL60 Density Meter

Features

- Bimetal temperature compensation ensures higher measurement accuracy.
- Suitable for indoor or outdoor installation.
- AISI 304 hermetically sealed stainless steel case.
- Gas connection tubes are made of AISI 316 stainless steel.
- The on-screen display value and output signals are independent of the impact of external environment, such as altitude.

Application

- SF₆ Gas Insulated RMU
- SF₆ Gas Insulated Switchgear

Options

- Process connection: customizable
- Measuring Medium: SF₆, Air, N₂, SF₆ + N₂ and other gases
- Suitable for High-altitude environment
- Wider temperature range: -40°C to +60°C
- Optional measurement accuracy: ±1.0%FS (+20±1°C), ±2.5%FS (-20°C~+60°C) (gas phase)

Technical Parameters

Case diameter	64mm
Scale range	1 to 2bar abs
Accuracy	±1.5%FS (+20±1°C), ±2.5%FS (-20°C~+60°C) (gas phase)
Degree of protection	IP65
Ambient conditions	-20° C to +60° C, relative humidity ≤ 95%RH
Leakage rate	≤ 1 × 10 ⁻⁹ Pa·m ³ /s (Helium leakage inspection)
Process connection	M24 × 1.5 (customizable)
Installation method	Radial or Axial
Watch glass	Laminated safety glass
Impact rating	30g
Weight	≈ 0.2kg
Pressure element	Bourdon tubes

Dimensions

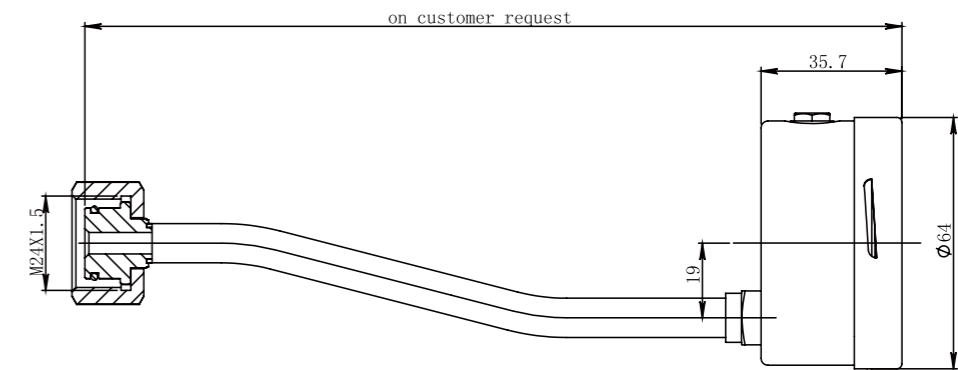

KL60 eccentric sample gauge size

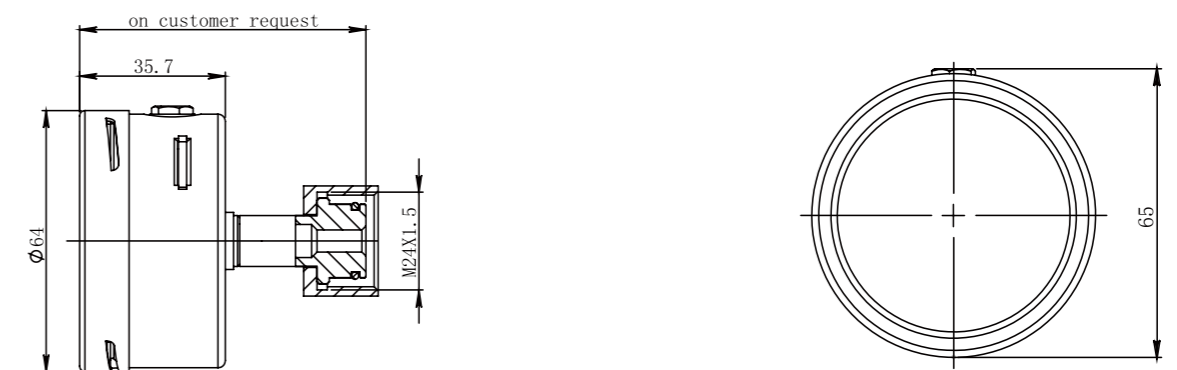

KL60 centerpiece sample gauge size