



Principle and characteristics

The TM120 is a resistive temperature sensor, resistance value will change with temperature And change. Simple installation, a variety of range optional, a variety of specifications probe optional, All stainless steel case, compact and strong structure. And optional cabinet control table Or rail type temperature transmitter with the output of industrial analog signals.

- Sensor direct output signal: Pt100/ Pt1000, 2-wire system, 3-wire System or 4-wire connection; Or integrated transmitter output analog signal 4... 20 mA
- Compact design, strong vibration resistance and fast response

Product application

TM120 meets hydraulic, lubrication, new energy, photovoltaic, automotive manufacturing And the measurement of temperature in various systems.

Wiring diagram

description

1	brown
4	black
3	blue

M12*1 connector

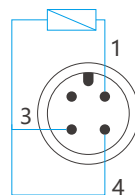

Technical parameter

- ◇ Dividing number: Pt100 (Measuring current: 0.1... 1.0 mA)
Pt1000 (Measuring current: 0.1... 0.3 mA)
- ◇ Measuring range: -60~200°C
- ◇ Accuracy level: Class A
- ◇ Allowable error: $\pm 0.15 + 0.002 \times t$
- ◇ Pressure resistance: Diameter of 6 probe 40bar
Diameter 8 probe 100bar
- ◇ Shell material: stainless steel
- ◇ Liquid contact material: Stainless steel 1.4571
- ◇ Electrical connection: M12 x 1 according to DIN EN 175301-803
- ◇ Protection level: IP67

Dimensional drawing (mm)

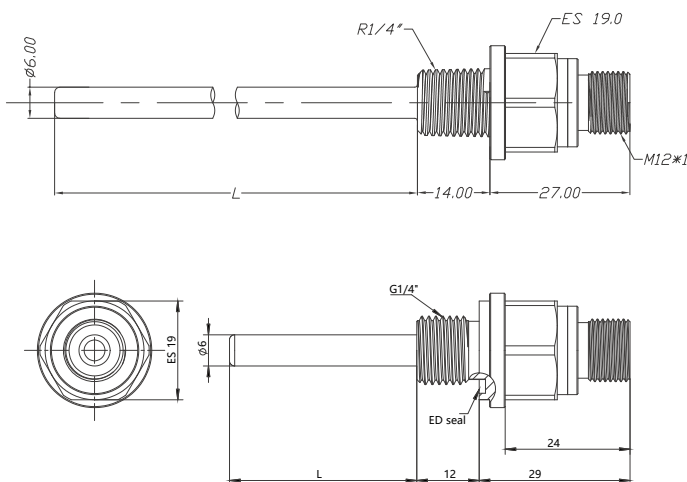

Selection table

TM120-	6	025	G14M	B	Detailed description
TM120-					Resistive temperature sensor
	6				The diameter of the probe is 6 mm
	8				The diameter of the probe is 8 mm
		025			The probe length L is 25mm
		050			The probe length L is 50mm
		075			Explore a length L of 75mm
		100			The probe length L is 100mm
			G14M		Threaded interface: G1/4 external thread
			R14M		Threaded interface: R1/4 external thread
				A	PT100
				B	PT1000