

**STAINLESS STEEL FLANGE  
THREE-WAY BALL VALVE**

不锈钢法兰三通球阀

**STAINLESS STEEL FLANGE  
THREE-WAY BALL VALVE**

不锈钢法兰三通球阀

Q44/644/944/45/645/945F-16C/P

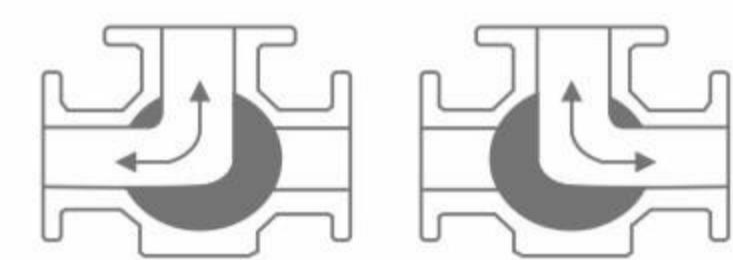
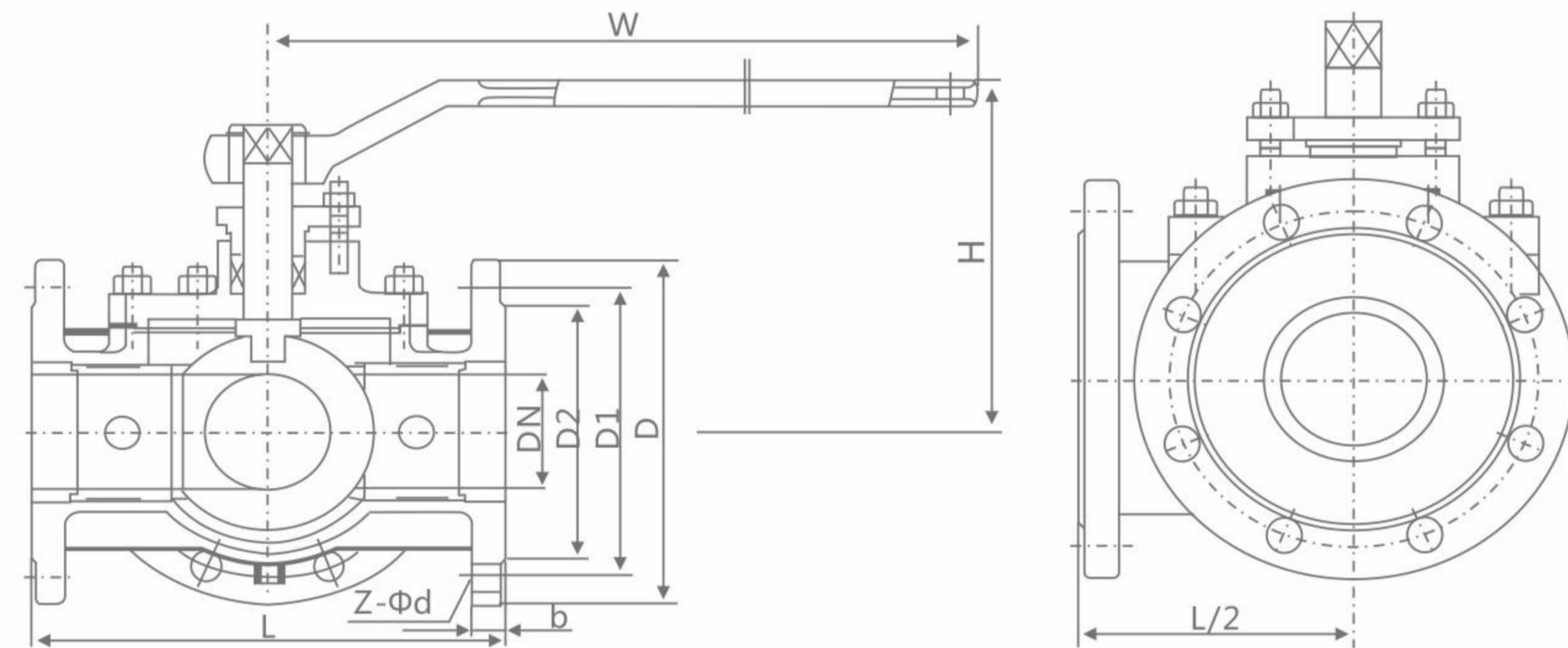

"L"型 L-type

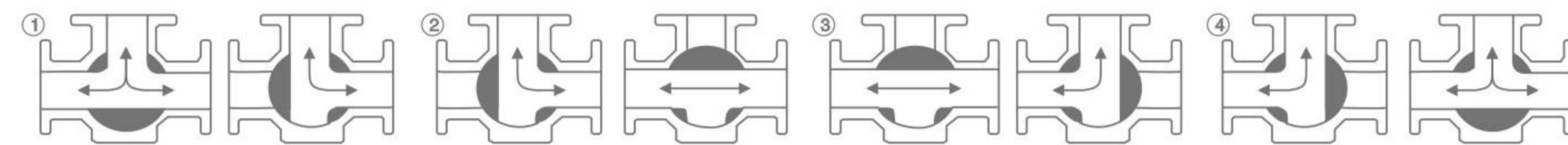

"T"型 T-type

主要外形和连接尺寸 Main external and connection dimension

JB/T79.1

公称通径 DN	主要外形尺寸和连接尺寸(mm) Main external and connection dimensions								WT(kg)
	L	D	D1	D2	b	Z-φd	H	W	
Q44F-16C Q44F-16P Q644F-16C Q644F-16P Q944F-16C Q944F-16P Q45F-16C Q45F-16P Q645F-16C Q645F-16P Q945F-16C Q945F-16P									
15	150	95	65	45	14	4-φ14	95	140	4
20	160	105	75	55	14	4-φ14	105	160	8
25	180	115	85	65	14	4-φ14	113	180	7
32	200	135	100	78	16	4-φ18	135	250	12
40	220	145	110	85	16	4-φ18	142	300	15
50	240	160	125	100	16	4-φ18	165	350	20
65	260	180	145	120	18	4-φ18	175	350	25
80	280	195	160	135	20	8-φ18	190	400	36
100	320	215	180	155	20	8-φ18	225	500	51
125	380	245	210	185	22	8-φ18	245	600	77
150	440	280	240	210	24	8-φ23	265	800	108
200	550	335	295	265	26	12-φ23	305	800	126
250	670	405	355	320	30	12-φ25	370	1300	185

主要外形和连接尺寸 Main external and connection dimension

JB/T79.1

公称通径 DN	主要外形尺寸和连接尺寸(mm) Main external and connection dimensions								WT(kg)
	L	D	D1	D2	D6	b	Z-φd	H	
Q44F-40 Q45F-40P Q644F-40 Q644F-40P Q944F-40 Q944F-40P Q45F-40 Q45F-40P Q644F-40 Q644F-40P Q944F-40 Q944F-40P									
15	150	95	65	45	16	4-φ14	95	100	4
20	160	105	75	55	16	4-φ14	105	160	5
25	180	115	85	65	16	4-φ14	113	160	8
32	200	135	100	78	18	4-φ18	135	250	13
40	220	145	110	85	18	4-φ18	142	250	19
50	240	160	125	100	20	4-φ18	154	350	27
65	260	180	145	120	22	8-φ18	175	350	33
80	280	195	160	135	22	8-φ18	190	450	40
100	320	230	190	160	24	8-φ23	225	450	53
125	380	270	220	188	28	8-φ25	245	600	86
150	440	300	250	218	30	8-φ25	265	800	113
200	550	360	310	278	34	12-φ25	305	1200	133
250	670	425	370	332	36	12-φ30	370	1400	219

主要外形和连接尺寸 Main external and connection dimension

JB/T79.2

公称通径 DN	主要外形尺寸和连接尺寸(mm) Main external and connection dimensions								WT(kg)
	L	D	D1	D2	D6	b	Z-φd	H	
Q44F-40 Q45F-40P Q644F-40 Q644F-40P Q944F-40 Q944F-40P Q45F-40 Q45F-40P Q644F-40 Q644F-40P Q944F-40 Q944F-40P									
15	180	95	65	45	40	16	4-φ14	100	4
20	190	105	75	55	51	16	4-φ14	160	5
25	200	115	85	65	58	16	4-φ14	160	8
32	210	135	100	78	66	18	4-φ18	250	13
40	230	145	110	85	76	18	4-φ18	250	19
50	250	160	125	100	88	20	4-φ18	350	27
80	310	195	160	135	121	22	8-φ18	450	40
100	350	230	190	160	150	24	8-φ23	450	53
125	381	270	220	188	176	28	8-φ25	600	86
150	403	300	250	218	204	30	8-φ25	800	113
200	502	375	320	282	260	38	12-φ30	1200	133
250	568	445	385	345	313	42	12-φ34	1400	219