

REV	CONTENT	CHK	DATE
V0.0	CONTENT	SK	2014/09/03

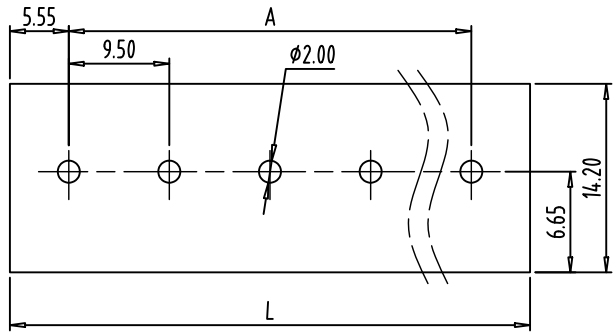

PCB LAYOUT
S=1.4:1

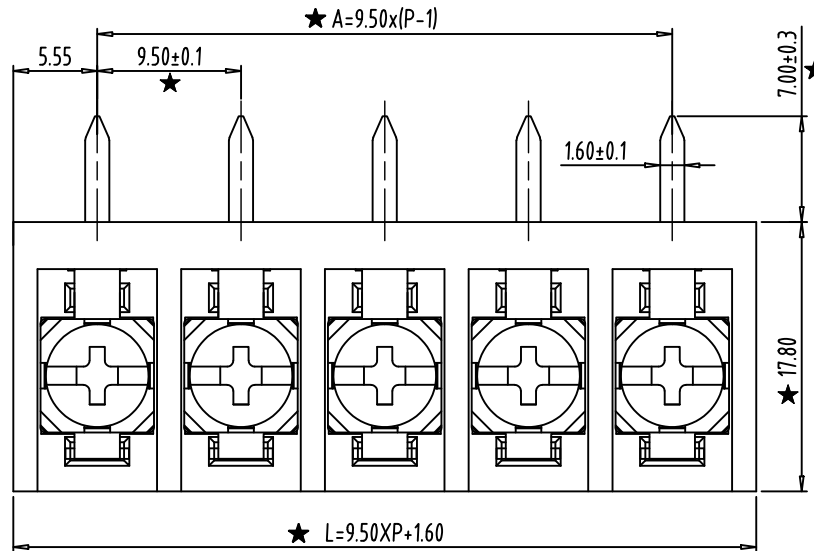

NOTES:

1. Rating: 300V 20A
2. Insulation Withstands Voltage: AC2000V/MIN
3. Insulation Resistance: 500MΩ or more at DC500V
4. Using Temperature Range: -40°C/+105°C
5. Screw Torque Value: 1.2N.m
6. Suitable Electric Wire: 12-22AWG
- 7, "★" the important dimension.

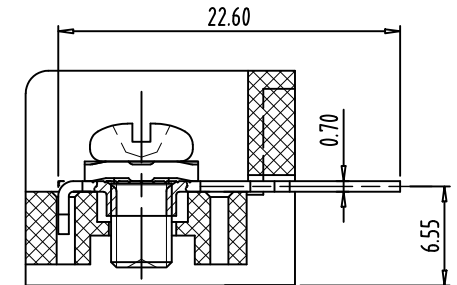
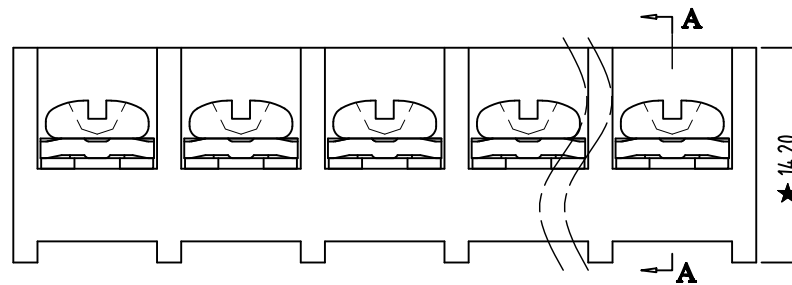
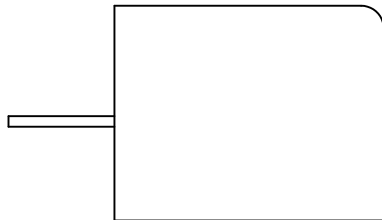

SECTION: A-A

Total Pitch Tolerances in mm										Nominal dimension range in mm										⊥	≡	—	//		
over 0	over 30	over 53	over 70	over 90	over 115	over 150	over 250	over 350	over 500	over 0	over 30	over 53	over 70	over 90	over 115	over 150	over 200	over 250	over 320	over 0	over 10	all	over 0	over 100	over 150
±0.18	±0.20	±0.25	±0.3	±0.35	±0.4	±0.60	±0.70	±0.85	±0.20	±0.25	±0.30	±0.35	±0.4	±0.45	±0.55	±0.70	±0.80	±0.90	±0.2	0.2	0.3	0.3	0.2	0.3	0.5

ITEM	NAME OF PART		NO. OF PART	Q'TY	MATERIAL			NOTE	
DWG.	SK	DATE	2014/09/03	SIZE	A4	UNITS	mm	SHEET/OF	1/1
CHK.		DATE		SCALE	2:1		HB9500横插		
APP		DATE		NAME		CM-46R-B			
Xiamen Fucon Electronics Co.,LTD					DWGNO.				