

# TECHNICAL DATA

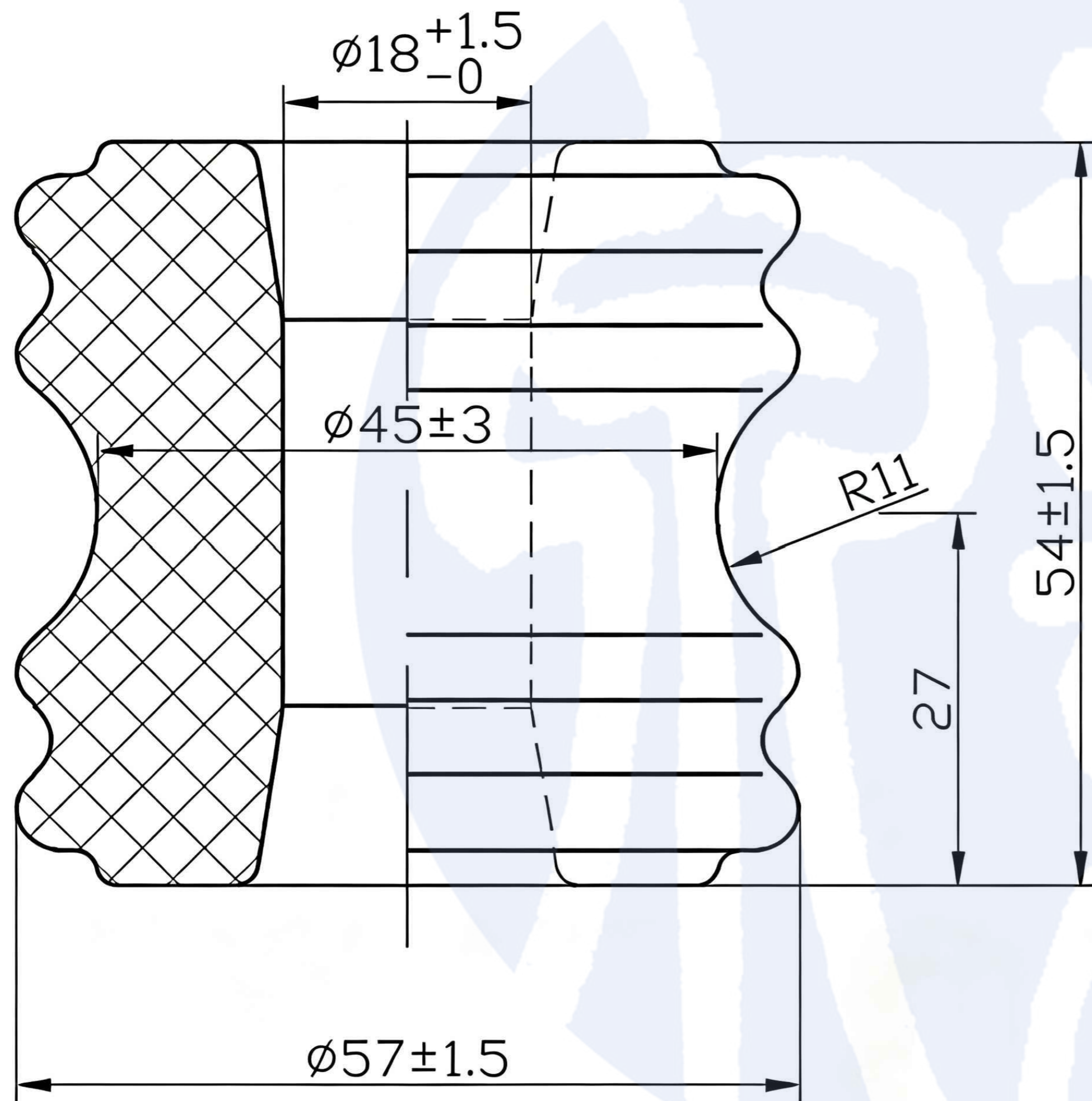

Type	ANSI 53-1
Standard Applied	ANSI C29.3
Main Dimensions	D: 57mm H: 54mm
Mechanical Tensile Strength	9.1kN
Low frequency dry flashover voltage	20kV
Low frequency wet flashover voltage, vertical	8kV
Low frequency wet flashover voltage, horizontal	10kV
MATERIAL: PORCELAIN	



**Jiangxi QOCI Electric CO.,LTD.**  
www.quanxinelectric.com



Spool Type  
Porcelain Insulator

**ANSI 53-1**

Design		Standard		Marker	
Num		Sigh			
Audit		Date		Weight	0.22KG
Notes		Approved		Scale	1:1