

SHF-20G1 PORCELAIN PIN INSULATOR

ШФ-20Г1, штыревой фарфоровый изолятор

Material: porcelain C-120

Glaze: brown

Fittings: Plastic screw sleeve K-6(Φ20)/K-7(Φ22)/K-9(Φ24)/K-10(Φ22)

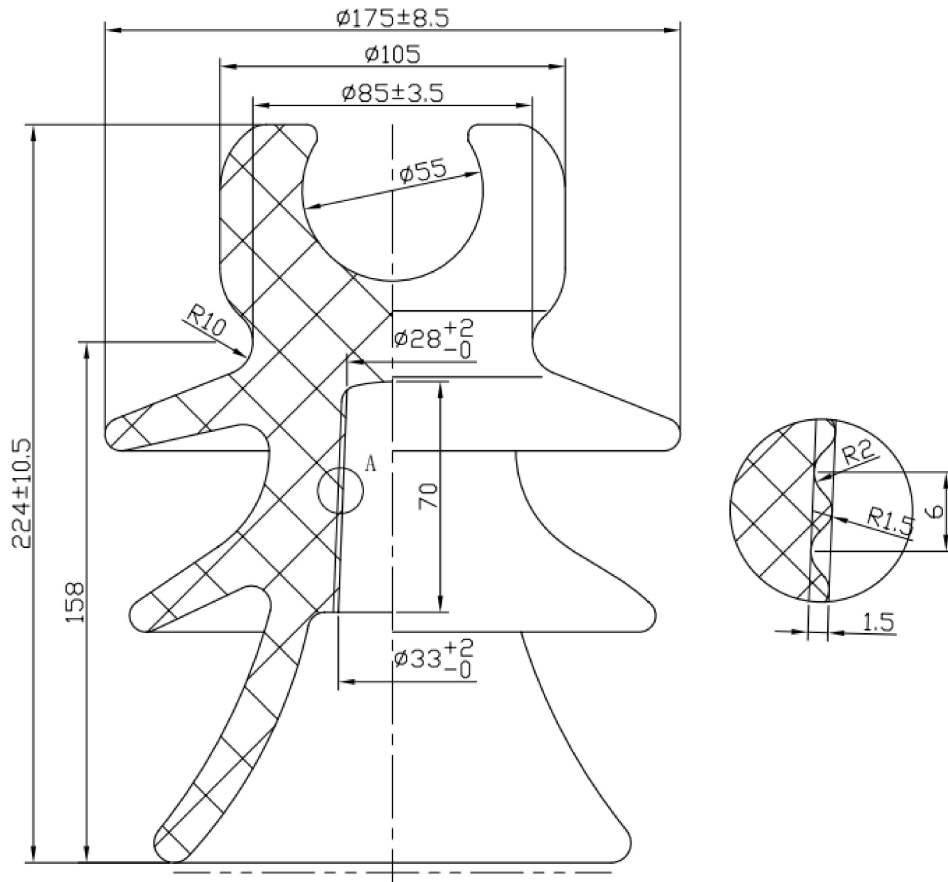

Type	SHF-20G1	
Russian-standard	ШФ-20Г1	
Overall Height(H)	mm	224
Max. Shed Diameter(D)	mm	175
Creepage Distance	mm	400
Cantilever Strength	kN	13
Power frequency wet withstand voltage	kV	65
Power frequency dry withstand voltage	kV	85
Impulse withstand voltage	kV	135
Puncture voltage	kV	190
Net Weight	kg	5.9

Jiangxi QOCI Electric Co., Ltd.

www.quanxinelectric.com