

Integrated Home Solar-Storage-charging System



Parameter/specification sheet

Integrated Home Solar-Storage-charging System (5KWh,5KW)

- 1.AC output rated power: 5kW, rated voltage: 220V, rated current: 23A
- 2.DC charging gun output rated power: 5kW, voltage: 200-1000V
- 3.AC input rated power: 2.2kW, rated voltage: 220V, rated current: 10A (approximately 2.5 hours to fully charge the battery)
- 4.Photovoltaic input maximum power: 2kW, input voltage: 60-400V, maximum current: 20A
- 5.Battery energy: 5kWh, maximum output power: 5kW
- 6.Charging control method: Button
- 7.Exposed gun cable length: 3 meters (customizable)
- 8.Charging gun standard: GBT/CCS1/CCS2/NACS/CHAdEMO (Single gun)
- 9.Human-machine interaction: 4.3-inch screen

Integrated Home Solar-Storage-charging System (10KWh,8KW)

- 1.AC output rated power: 8kW, rated voltage: 220V, rated current: 36.4A
- 2.DC charging gun output rated power: 7kW, voltage: 200-1000V
- 3.AC input rated power: 4.4W, rated voltage: 220V, rated current: 20A (approximately 2.5 hours to fully charge the battery)
- 4.Photovoltaic input maximum power: 4kW, input voltage: 60-400V, maximum current: 20A
- 5.Battery energy: 10kWh, maximum output power: 10kW
- 6.Charging control method: Button
- 7.Exposed gun cable length: 3 meters (customizable)
- 8.Charging gun standard: GBT/CCS1/CCS2/NACS/CHAdEMO (Single gun)
- 9.Human-machine interaction: 4.3-inch screen

Integrated Home Solar-Storage-charging System (15KWh,10KW)

- 1.AC output rated power: 10kW, rated voltage: 220V, rated current: 45.5A
- 2.DC charging gun output rated power: 7kW, voltage: 200-1000V
- 3.AC input rated power: 4.5kW, rated voltage: 220V, rated current: 22.7A (approximately 3.5 hours to fully charge the battery)
- 4.Photovoltaic input maximum power: 4.5kW, input voltage: 60-400V, maximum current: 30A
- 5.Battery energy: 15kWh, maximum output power: 15kW
- 6.Charging control method: Button
- 7.Exposed gun cable length: 3 meters (customizable)
- 8.Charging gun standard: GBT/CCS1/CCS2/NACS/CHAdEMO (Single gun)
- 9.Human-machine interaction: 4.3-inch screen

Integrated Home Solar-Storage-charging System (20KWh,10KW)

- 1.AC output rated power: 10kW, rated voltage: 220V, rated current: 45.5A
- 2.DC charging gun output rated power: 7kW, voltage: 200-1000V
- 3.AC input rated power: 5kW, rated voltage: 220V, rated current: 22.7A (approximately 4.5 hours to fully charge the battery)
- 4.Photovoltaic input maximum power: 4.5kW, input voltage: 60-400V, maximum current: 30A
- 5.Battery energy: 20kWh, maximum output power: 20kW
- 6.Charging control method: Button
- 7.Exposed gun cable length: 3 meters (customizable)
- 8.Charging gun standard: GBT/CCS1/CCS2/NACS/CHAdEMO (Single gun)
- 9.Human-machine interaction: 4.3-inch screen

Product appearance and structural diagram

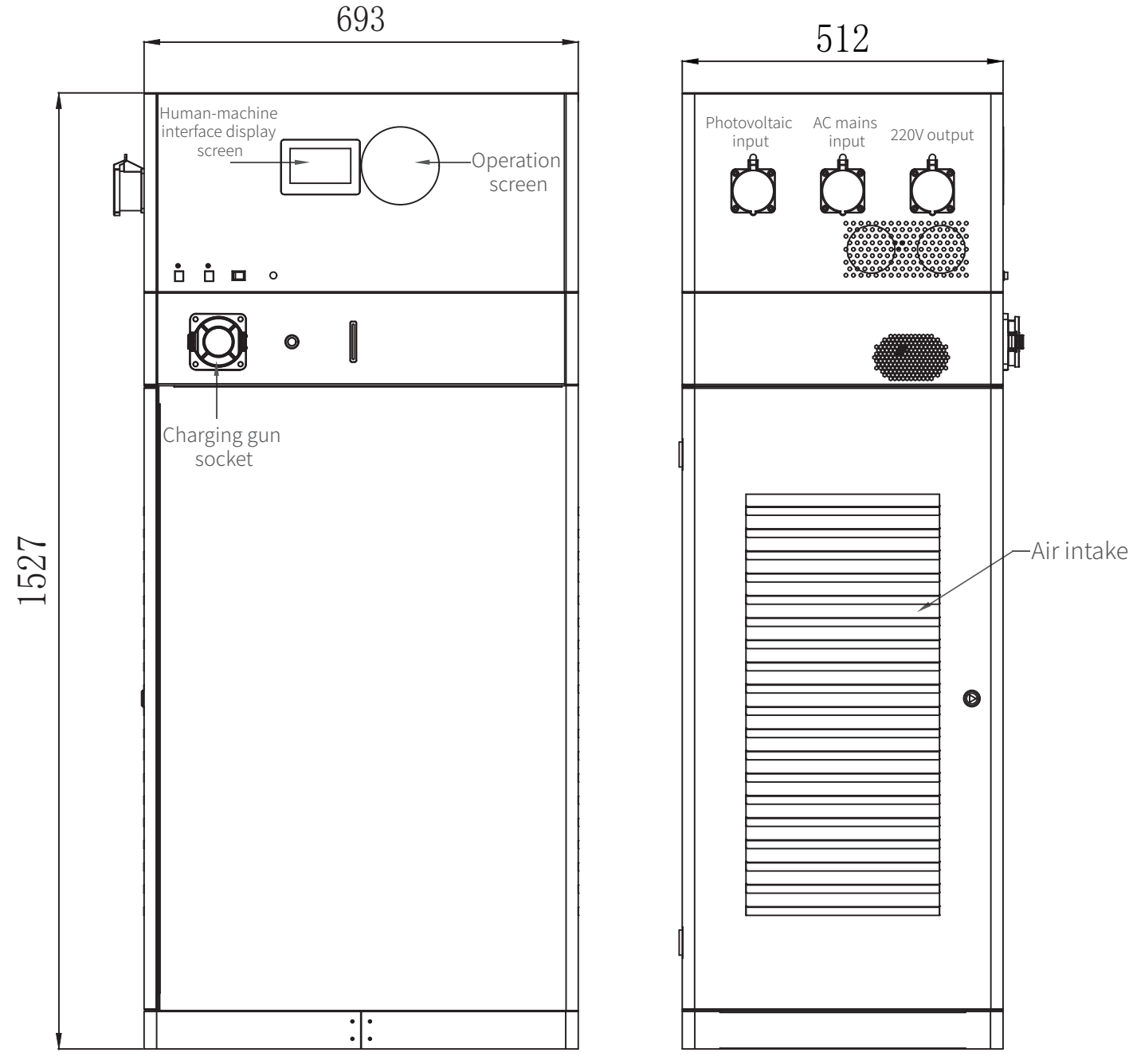

Unit:mm

usage method

Photovoltaic charging

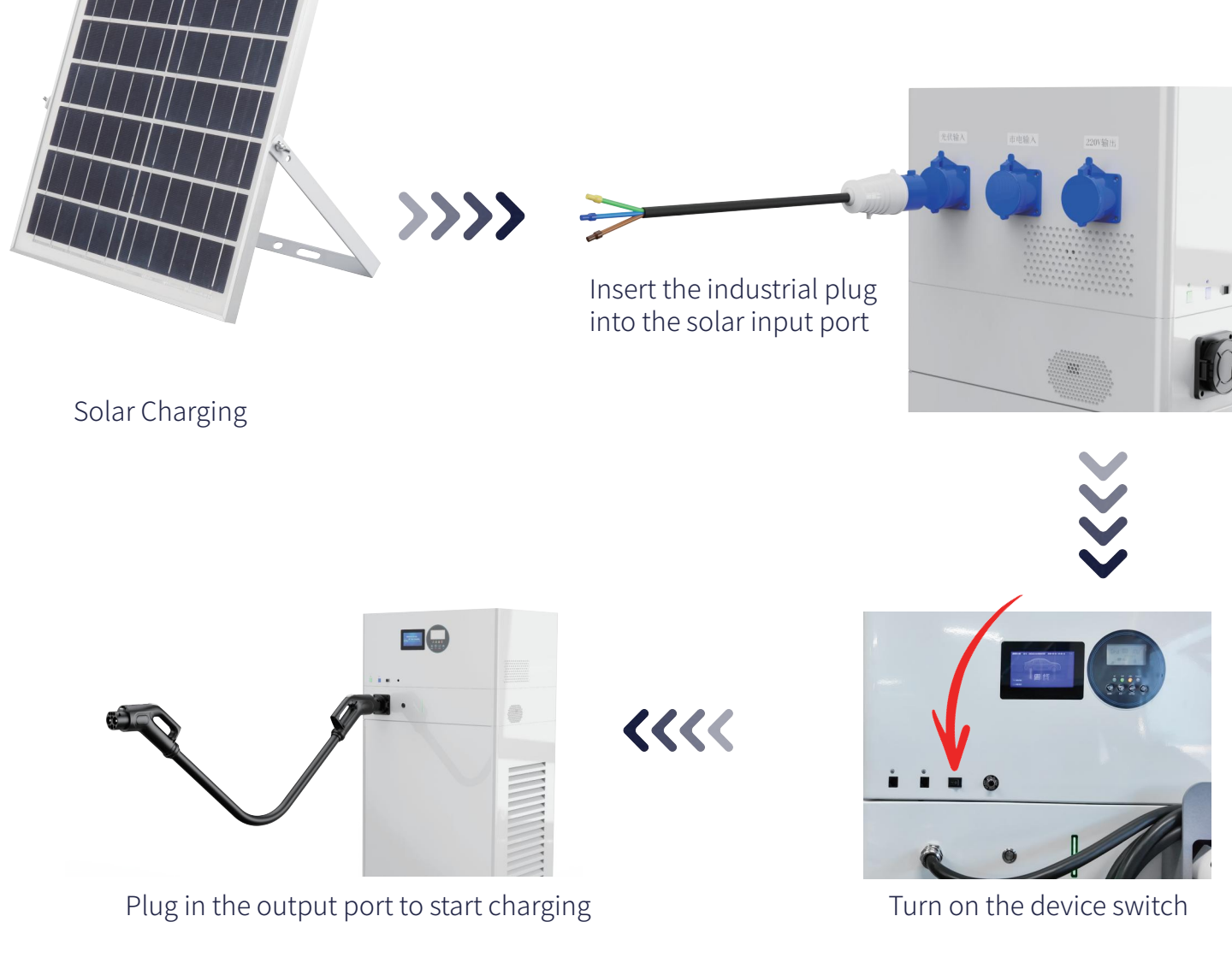

AC mains charging



Battery charging

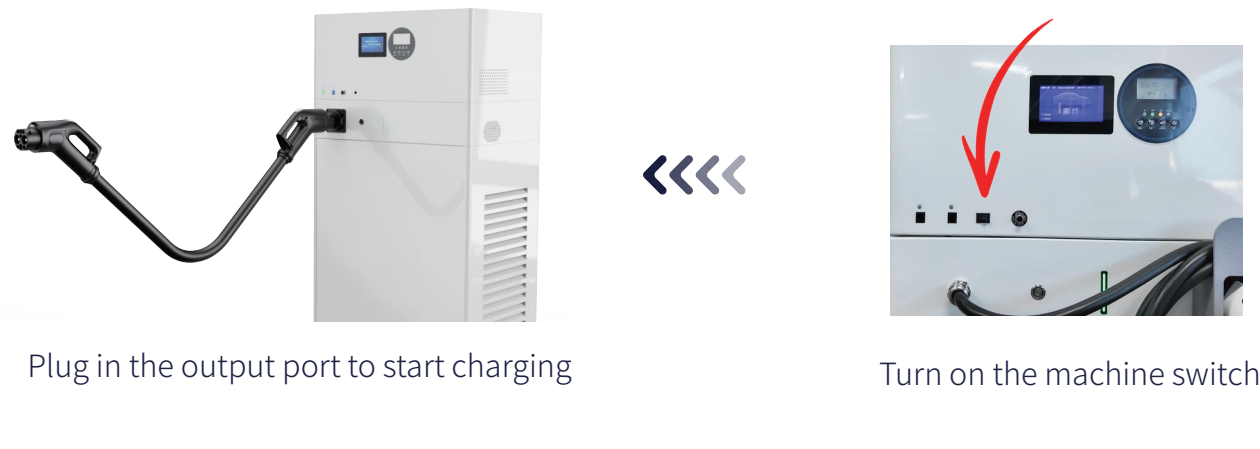

Indicator Lights

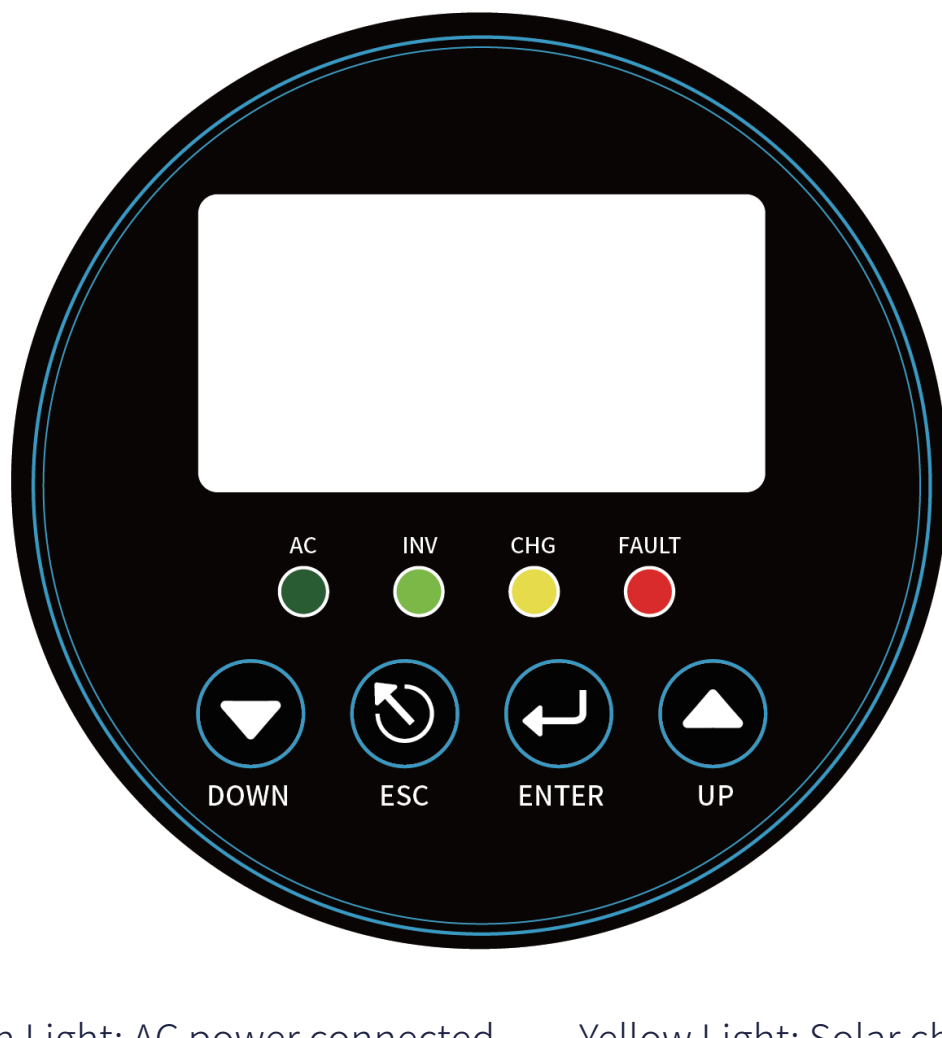

Dark Green Light: AC power connected. Yellow Light: Solar charging active.
Light Green Light: System in operation. Red Light: Fault detected.

Note: Pre-configured settings require no adjustment.

Application scenarios

