

# Industrial Remote Control

**XINDALI**  
— Since 1997 —

## XDL19 Industrial Remote Control Series

FOCUS ON INNOVATION

### FOR INDUSTRIAL CRANE



XDL19-F21-8



XDL19-F21-2



XDL19-F21-4



XDL19-F21-6

### FOR TRUCK TAILBOARD



XDL19-XCD-3



XDL19-XCD-4

CE FC

### XINDALI Remote control emitter

- Its appearance design compiles with human engineering, which is compact, light, and comfortable to operate.
- Correr button setting, clear function indication.
- Sensitive button, medium pressing power.
- Reasonable function button setting avoids fault operation effectively.
- Clear indication of communication signals.
- There is alarm indication for battery electric quantity is less than 3/5 of the original, a corresponding yellow alarm indicating lamp will slow blinking.
- State indication. There are corresponding indications for different Operating state.
- "Emergency stop" button for convenient operation
- Nice and elegant appearance
- Protection degree IP65

### XINDALI Remote control receiver

- Small and elegant appearance
- Protection degree IP 65
- Clear outgoing line mark and wiring connection
- Easy installation with clear display of each function Indicator lights
- With various kinds of power supply signal, emergency stop, segment and power on.
- Embedded antenna with sensitive receiving.

### Technical parameter

Material of Housing	Glass fiber reinforced nylon
Controlling Distance	Within 200M
Protection Level	IP65
Controller Power	3.7V (2000mAh Battery)
Receiver Rated Voltage	AC36V、AC220V、AC380V、DC12V~24V
Frequency Range	415~435MHz
Power of Signal Transmit	≤10dBm
Receiver Sensitivity	≥-110dBm
Power Consumption	< 5W
Cable Length/Size	1.2M (can be customized) /0.75mm <sup>2</sup>
Surrounding Temperature	-35℃~+55℃
Air relative humidity	< 90%RH
Air Pressure	86~106KPa
Controller Dimension	8 buttons (L158mm×W56mm×H47mm) 6 buttons (L138mm×W56mm×H47mm)
Receiver Dimension	L195mm×W85mm×H62mm
Weight	Controller: 180g, Receiver: 650~950g.

# Industrial Remote Control

## XDL19 Industrial Remote Control Series

FOCUS ON INNOVATION

### Dimensions

Transmitter

2~6 push-buttons

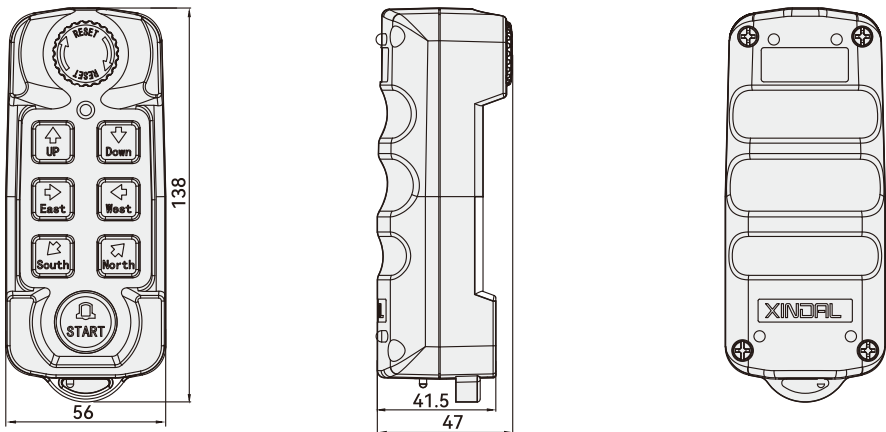

8 push-buttons

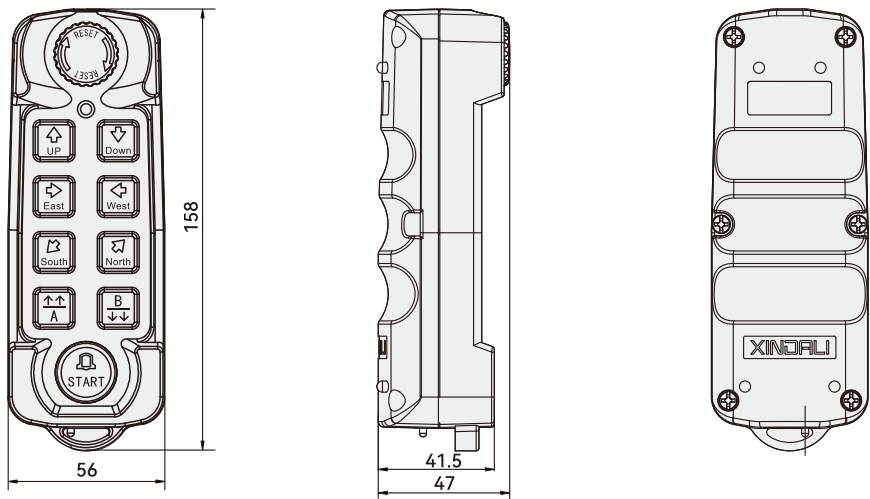

Receiver

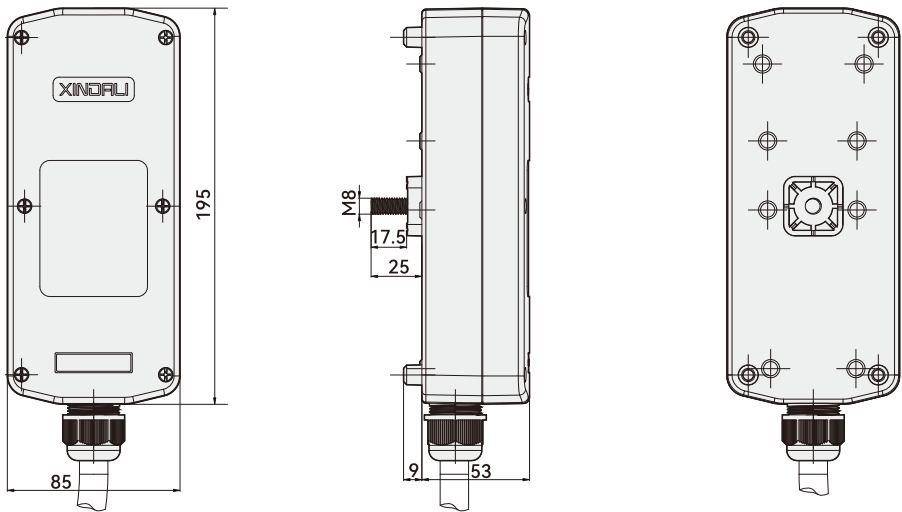

(Unit: mm)