

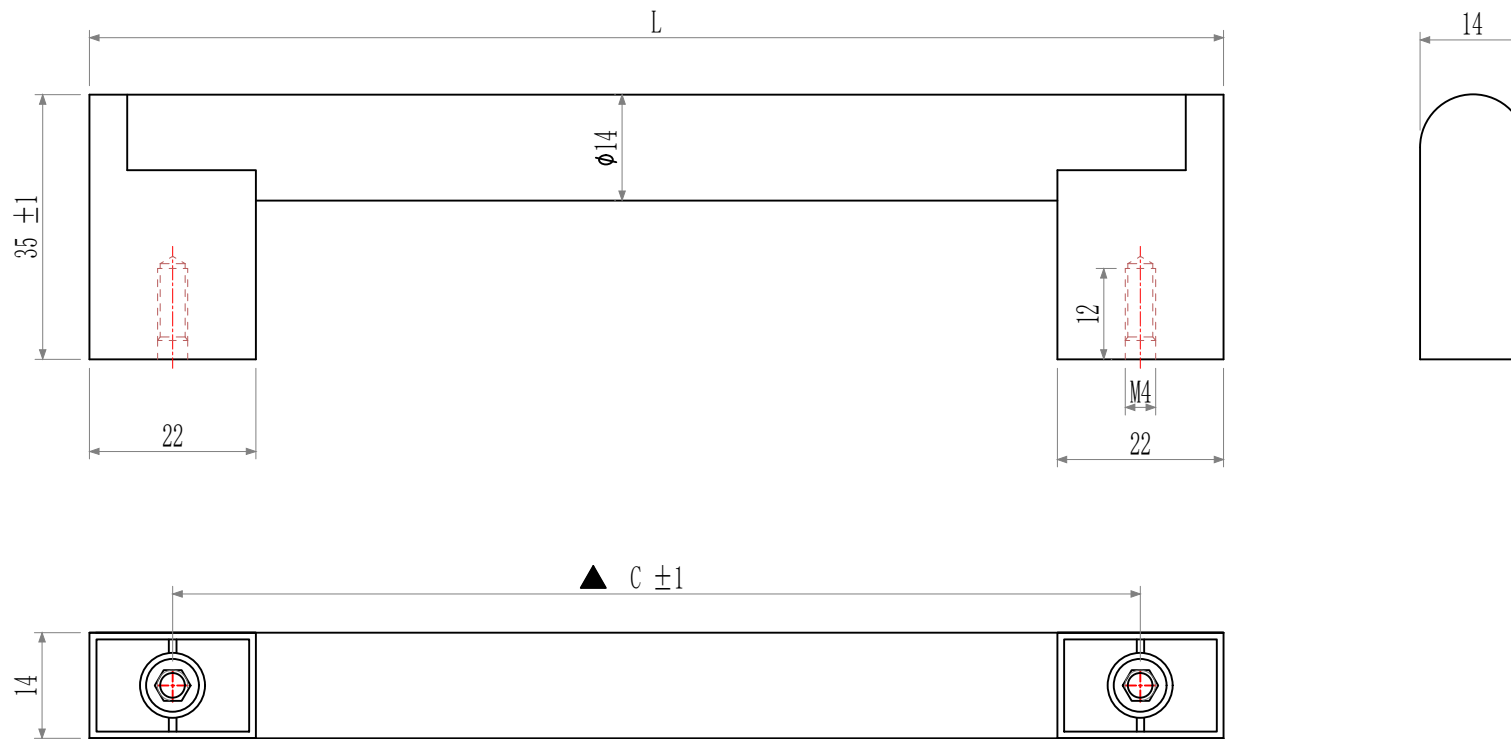

C	L
128	150
160	182
192	214
256	278
320	342
209	231
309	331
384	406
480	502
762	784
1080	1102



range of sizes	tolerance
0~3mm	±0.05mm
3~10mm	±0.1mm
10~30mm	±0.25mm
30~100mm	±1mm
100~300mm	±3mm
Over 300mm	±5mm



Technical requirement
 1. Material: The main structure is 201SS+Zamac.
 2. Surface treatment: according to contract order requirements.

drawing no: M18034-01B	
Item: Stainless steel round type hollow handle with square leg	
Page 1 of 1	Unit: mm
Main size: ▲	Proportion: 1:1
Drawing: Ivan	Date:2023-02-28
examination:Hugo	Date:2023-03-08
revise mark: ▲	
reviser:	Date:
describe:	