

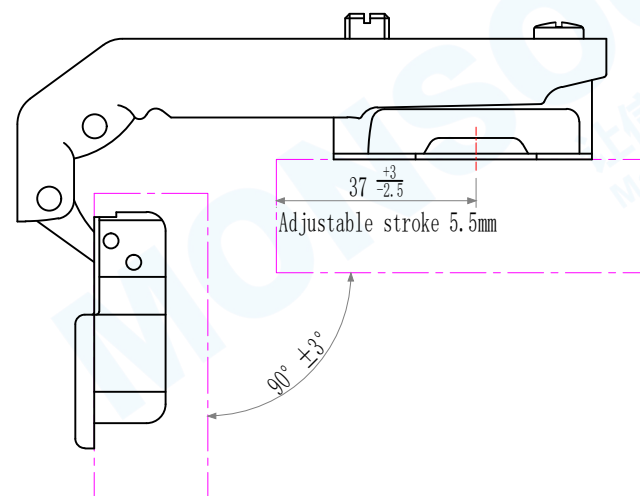

A * B
52*5.5
48*6
45*9.5

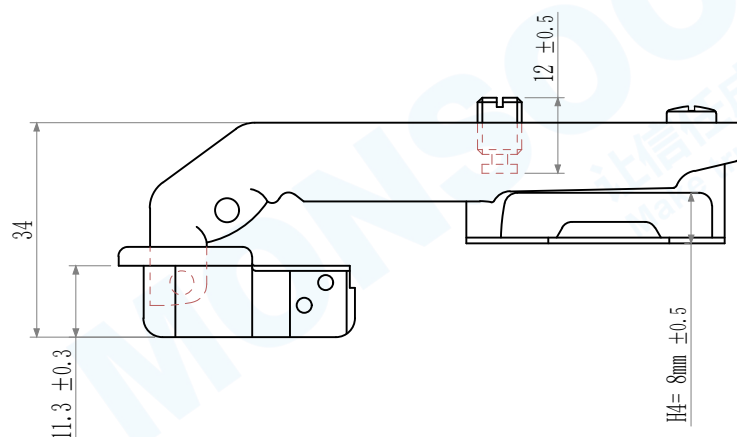
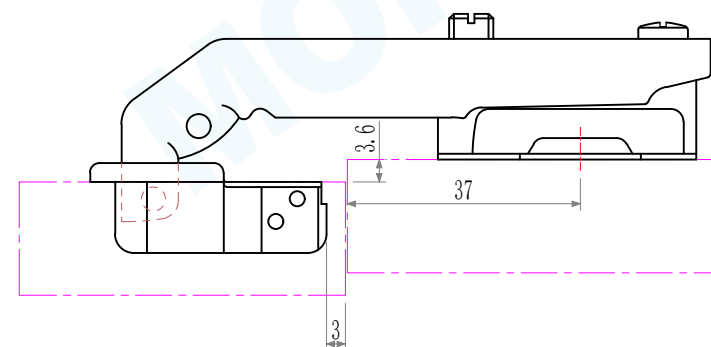
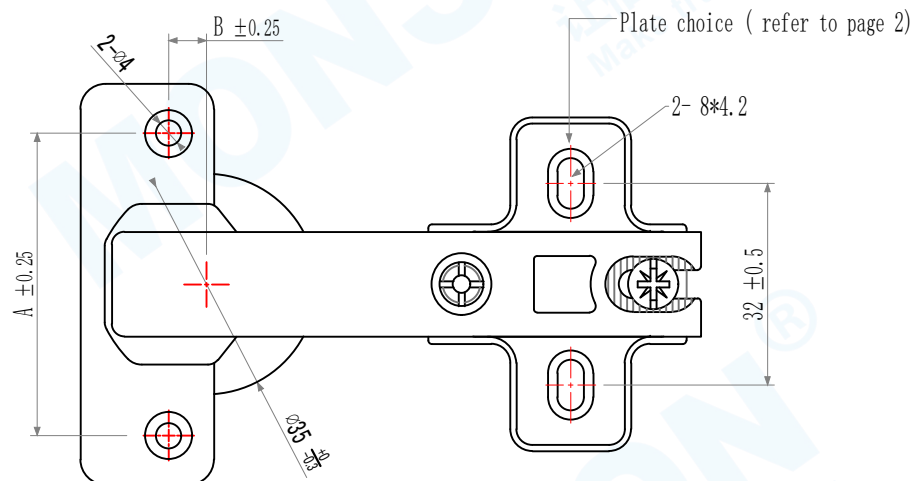

range of sizes	tolerance
0~3mm	±0.05mm
3~10mm	±0.1mm
10~30mm	±0.25mm
30~100mm	±1mm
100~300mm	±3mm
Over 300mm	±5mm

Technical requirement
 1. Material: The main structure is iron.
 2. Surface treatment: according to contract order requirements.

drawing no: M02128-01B

Item: Φ35 90° angle hinge

Page 1 of 2 Unit: mm

Main size: ▲ Proportion:1:1.2

Drawing: Ivan Date:2023-03-07

examination:Hugo Date:2023-03-08

revise mark: ▲

reviser: Date:

describe:

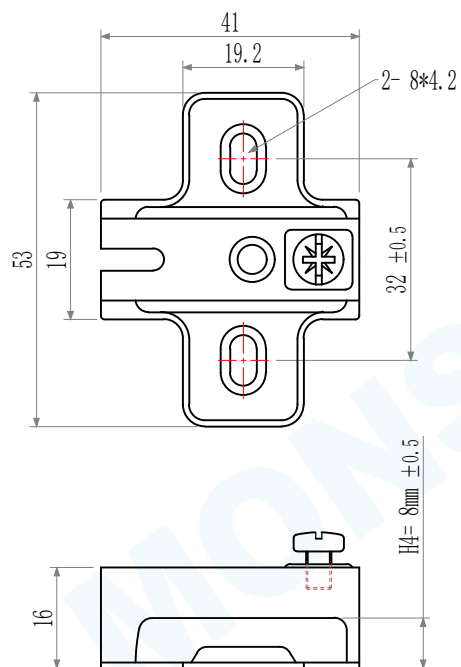

range of sizes	tolerance
0~3mm	$\pm 0.05\text{mm}$
3~10mm	$\pm 0.1\text{mm}$
10~30mm	$\pm 0.25\text{mm}$
30~100mm	$\pm 1\text{mm}$
100~300mm	$\pm 3\text{mm}$
Over 300mm	$\pm 5\text{mm}$

Technical requirement
 1. Material: The main structure is iron.
 2. Surface treatment: according to contract order requirements.

drawing no: M02128-01B	
Item: Plate choice	
Page 2 of 2	Unit: mm
Main size: ▲	Proportion: 1:1.2
Drawing: Ivan	Date: 2023-03-07
examination: Hugo	Date: 2023-03-08
revise mark: ▲	⊙
reviser:	Date:
describe:	