

SG1202 High Voltage Isolation Transformer

LI116V2/2016

1.Features

- ① Fully-encapsulated printed circuit board being able to be directly welded and assembled, easy to use, with aesthetic appearance;
- ② Compact structure, strong, vibration resistance, moisture-proof, flame retardant;
- ③ Small no-load current, high power factor, wide input overvoltage range;
- ④ Anti-electric strength up to 12kV;
- ⑤ Able to be added flexible wire as pin-out according to user requirements..

2. Ambient Conditions

- ① Temperature: $-25^{\circ}\text{C} \sim +70^{\circ}\text{C}$;
- ② Relative humidity: $\leq 90\%$ at 40°C ;
- ③ Atmospheric pressure: $860 \sim 1060\text{mbar}$ ($650 \sim 800\text{mmHg}$ approximately).

3. Insulation Rating: Class B (130°C)

4. Safety Characteristics

- ① Dielectric resistance: $>1000\text{M}\Omega$ in normal condition;
- ② Insulation withstand voltages: $12\text{KV} / 1 \text{ min}$;
- ③ Insulation impact strength: Continuously 20 times impact of $6\text{KV}/50\mu\text{S}$;
- ④ Fire retardancy: In conformity with UL94-V0.

5. Safety approval: CE

6. Rated Power: 2VA

7. Outline, Installation Dimension and Detailed Technical Parameters

- ① Pin-out outline dimension and layout:

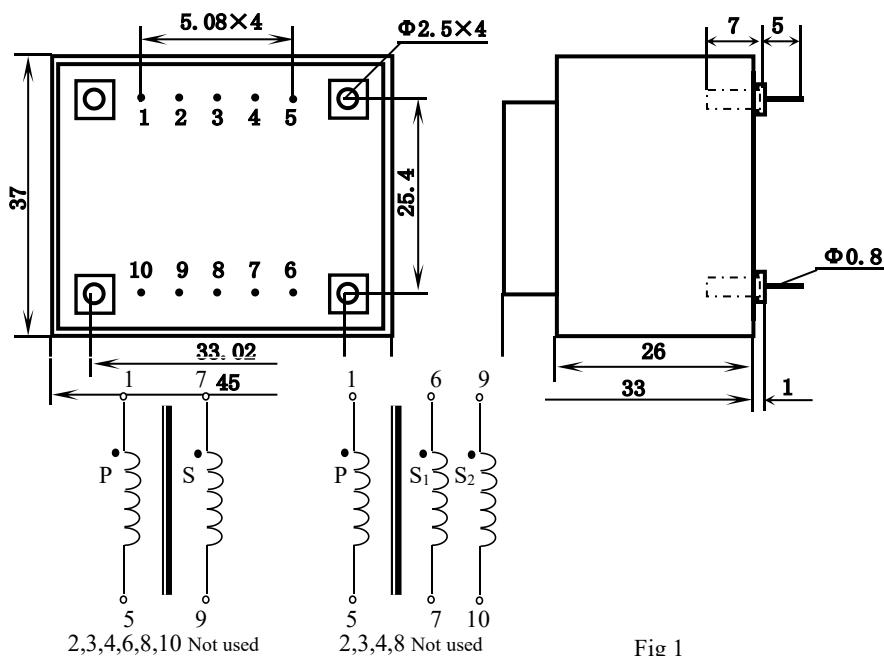

Fig 1

Outline, Installation Dimension and Detailed Technical Parameters

② Pin-out outline dimension and layout:

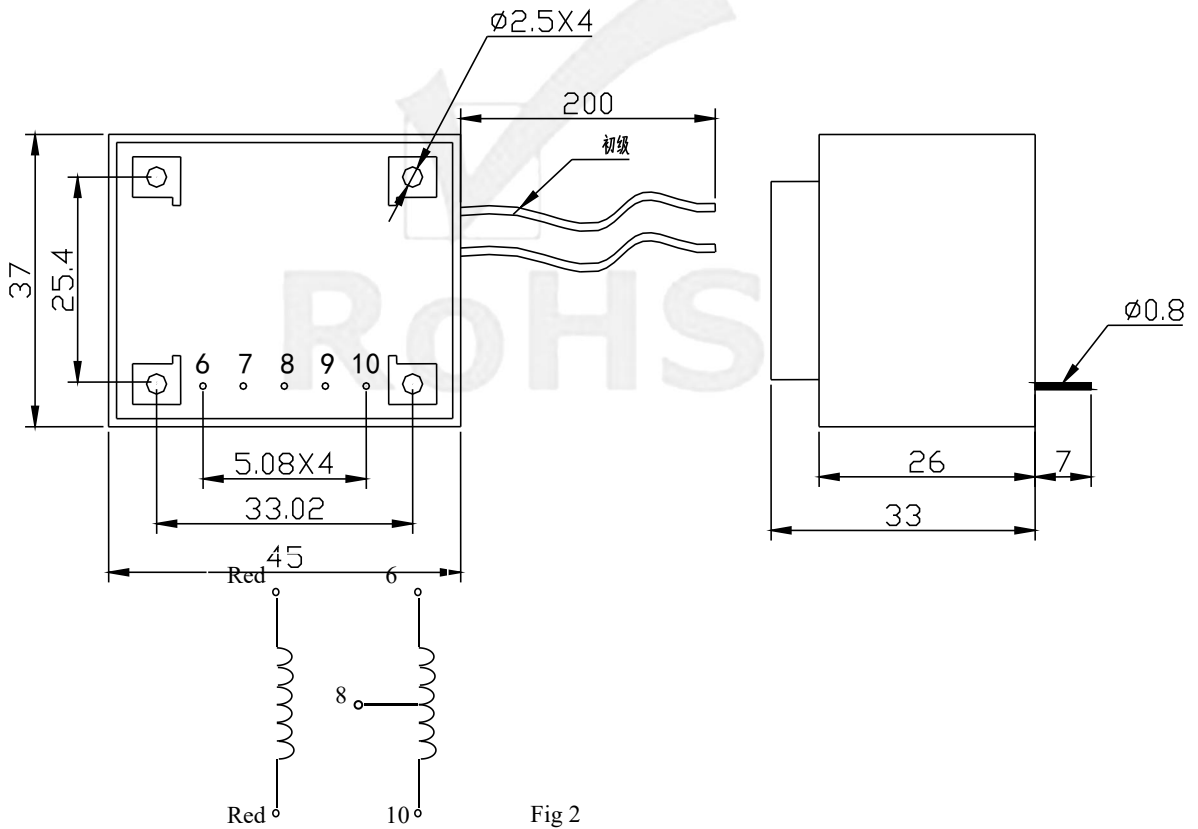

Fig 2

7、9 Not used

Input Feature	Pins	Input voltage	Idle Current	Output Power	Pin Layout
	flexible wire		220V/50Hz	≤18mA	
Output Feature	Pins	Idle Voltage	Full Load Voltage	Rated Voltage	Fig 2
	6-8-10	2×6.6V	2×6V	167mA	
Safety Feature	Primary to secondary				
	≥12kV/60s				

This series of products are customized. Other parameters can be designed according to customer requirements.

SG1208 High Voltage Isolation Transformer

LI117V2/2016

1. Features

- ① Fully-encapsulated printed circuit board being able to be directly welded and assembled, easy to use, with aesthetic appearance;
- ② Compact structure, strong, vibration resistance, moisture-proof, flame retardant;
- ③ Small no-load current, high power factor, wide input overvoltage range;
- ④ Anti-electric strength up to 12kV;
- ⑤ Able to be added flexible wire as pin-out according to user requirements.

2. Ambient Conditions

- ① Temperature: $-25^{\circ}\text{C} \sim +70^{\circ}\text{C}$;
- ② Relative humidity: $\leq 90\%$ at 40°C ;
- ③ Atmospheric pressure: 860~1060mbar (650~800mmHg approximately).

3. Insulation Rating: Class B (130°C)

4. Safety Characteristics

- ① Dielectric resistance: $>1000\text{M}\Omega$ in normal condition;
- ② Insulation withstand voltages: 12KV / 1 min;
- ③ Insulation impact strength: Continuously 20 times impact of 6KV/50 μS ;
- ④ Fire retardancy: In conformity with UL94-V0.

5. Safety approval: CE

6. Rated Power: 8VA

7. Outline, Installation Dimension and Detailed Technical Parameters

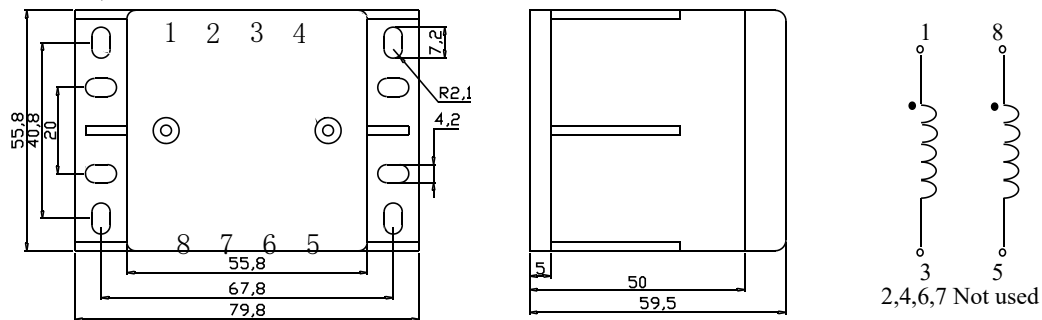

Input Feature	Pins	Input voltage	Idle Current	Output Power	Pin Layout
	1-3	220V/50Hz	$\leq 22\text{mA}$	8VA	
Output Feature	Pins	Idle Voltage	Full Load Voltage	Rated Voltage	Fig above
	5-8	11.7V	10V	800mA	
Safety Feature	Primary to secondary				
	$\geq 12\text{kV}/60\text{s}$				

This series of products are customized. Other parameters can be designed according to customer requirements.

SG1515 High Voltage Isolation Transformer

LI196V2/2016

1. Features

- ① Fully-encapsulated printed circuit board being able to be directly welded and assembled, easy to use, with aesthetic appearance;
- ② Compact structure, strong, vibration resistance, moisture-proof, flame retardant;
- ③ Small no-load current, high power factor, wide input overvoltage range;
- ④ Anti-electric strength up to 15kV.
- ⑤ Able to be used as PCB welding leads, parameters can be designed according to user requirements.

2. Ambient Conditions

- ① Temperature: $-25^{\circ}\text{C} \sim +70^{\circ}\text{C}$;
- ② Relative humidity: $\leq 90\%$ at 40°C ;
- ③ Atmospheric pressure: $860 \sim 1060\text{mbar}$ ($650 \sim 800\text{mmHg}$ approximately).

3. Insulation Rating: Class B (130°C)

4. Safety Characteristics

- ① Dielectric resistance: $> 1000\text{M}\Omega$ in normal condition;
- ② Insulation withstand voltages: $12\text{KV} / 1 \text{ min}$;
- ③ Insulation impact strength: Continuously 20 times impact of $6\text{KV}/50\mu\text{S}$;
- ④ Fire retardancy: In conformity with UL94-V0.

5. Safety approval:

6. Rated Power: 15VA

7. Outline, Installation Dimension and Detailed Technical Parameters

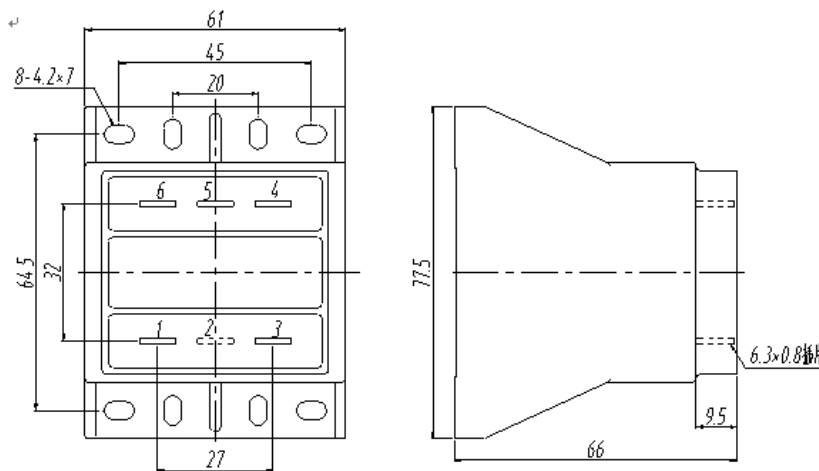

8.Existing model parameter

SG1515-01

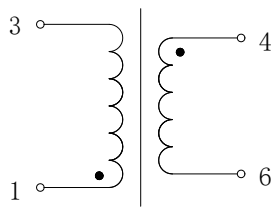

Unused pins do not lead out

Fig 2

Input Feature	Pins	Input voltage	Idle Current	Output Power	Pin Layout
	1-3	220V/50/60Hz	≤35mA	15VA	Fig 2
Output Feature	Pins	Idle Voltage	Full load Voltage		
	4-6	24V	27V		
Safety Feature	Primary to secondary				
	≥15kV/60s				

This series of products are customized. Other parameters can be designed according to customer requirements.

SG2505 High Voltage Isolation Transformer

LI152V2/2016

1.Features

- ① Fully-encapsulated printed circuit board being able to be directly welded and assembled, easy to use, with aesthetic appearance;
- ② Compact structure, strong, vibration resistance, moisture-proof, flame retardant;
- ③ Small no-load current, high power factor, wide input overvoltage range;
- ④ Anti-electric strength up to 12kV;
- ⑤ Able to be added flexible wire as pin-out according to user requirements.
- ⑥ Parameters can be designed according to user requirements.

2. Ambient Conditions

- ① Temperature: $-25^{\circ}\text{C} \sim +70^{\circ}\text{C}$;
- ② Relative humidity: $\leq 90\%$ at 40°C ;
- ③ Atmospheric pressure: 860~1060mbar (650~800mmHg approximately).

3. Insulation Rating: Class B (130°C)

4. Safety Characteristics

- ① Dielectric resistance: $>1000\text{M}\Omega$ in normal condition;
- ② Insulation withstand voltages: 12KV / 1 min;
- ③ Insulation impact strength: Continuously 20 times impact of 6KV/50 μS ;
- ④ Fire retardancy: In conformity with UL94-V0.

6. Safety approval:



6. Rated Power: 5VA

7.Outline, Installation Dimension and Detailed Technical Parameters

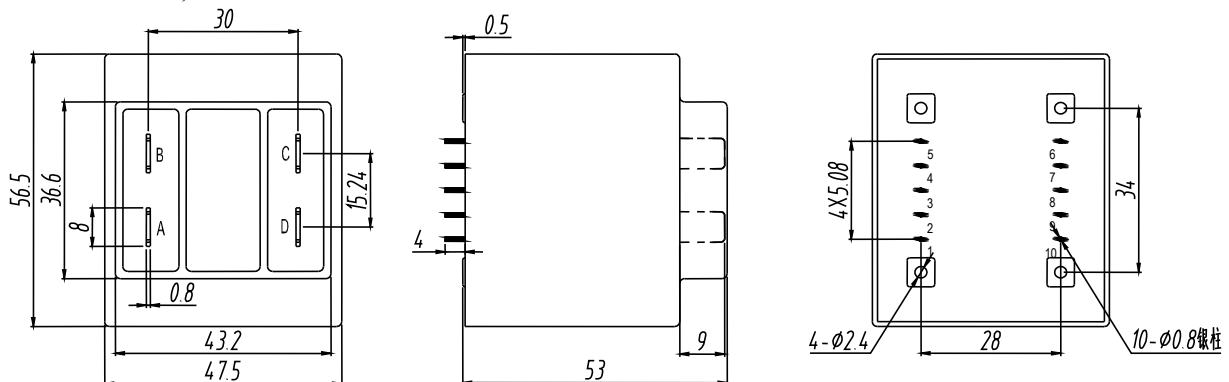
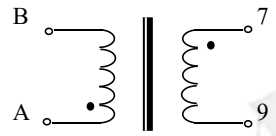

Fig 1

8. Existing model parameter

SG2505-01



Unused pins do not lead out

Fig 2

Input Feature	Pins	Input voltage	Idle Current	Output Power	Pin Layout
	A-B	220V/50/60Hz	$\leq 20\text{mA}$	5VA	Fig 2
Output Feature	Pins	Idle Voltage			
	7-9	12.5V			
Safety Feature	Primary to secondary				
	$\geq 25\text{kV}/60\text{s}$				

SG2505-02

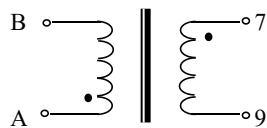

Unused pins do not lead out

Fig 3

Input Feature	Pins	Input voltage	Idle Current	Output Power	Pin Layout
	A-B	220V/50/60Hz	$\leq 20\text{mA}$	5VA	Fig 3
Output Feature	Pins	Idle Voltage	Full Load Voltage	Full Load Current	
	7-9	7V	6V	0.833A	
Safety Feature	Primary to secondary				
	$\geq 25\text{kV}/60\text{s}$				

This series of products are customized. Other parameters can be designed according to customer requirements.

SG3505 High Voltage Isolation Transformer

1.Features

- ① Fully-encapsulated printed circuit board being able to be directly welded and assembled, easy to use, with aesthetic appearance;
- ② Compact structure, strong, vibration resistance, moisture-proof, flame retardant;
- ③ Small no-load current, high power factor, wide input overvoltage range;
- ④ Anti-electric strength up to 35kV.

2. Ambient Conditions

- ① Temperature: $-25^{\circ}\text{C} \sim +70^{\circ}\text{C}$;
- ② Relative humidity: $\leq 90\%$ at 40°C ;
- ③ Atmospheric pressure: $860 \sim 1060\text{mbar}$ ($650 \sim 800\text{mmHg}$ approximately).

3. Insulation Rating: Class B (130°C)

4. Safety Characteristics

- ① Dielectric resistance: $>1000\text{M}\Omega$ in normal condition;
- ② Insulation withstand voltages: $12\text{KV} / 1 \text{ min}$;
- ③ Insulation impact strength: Continuously 20 times impact of $6\text{KV}/50\mu\text{S}$;
- ④ Fire retardancy: In conformity with UL94-V0.

7. Safety approval:



6. Rated Power: 5VA

7.Outline, Installation Dimension and Detailed Technical Parameters

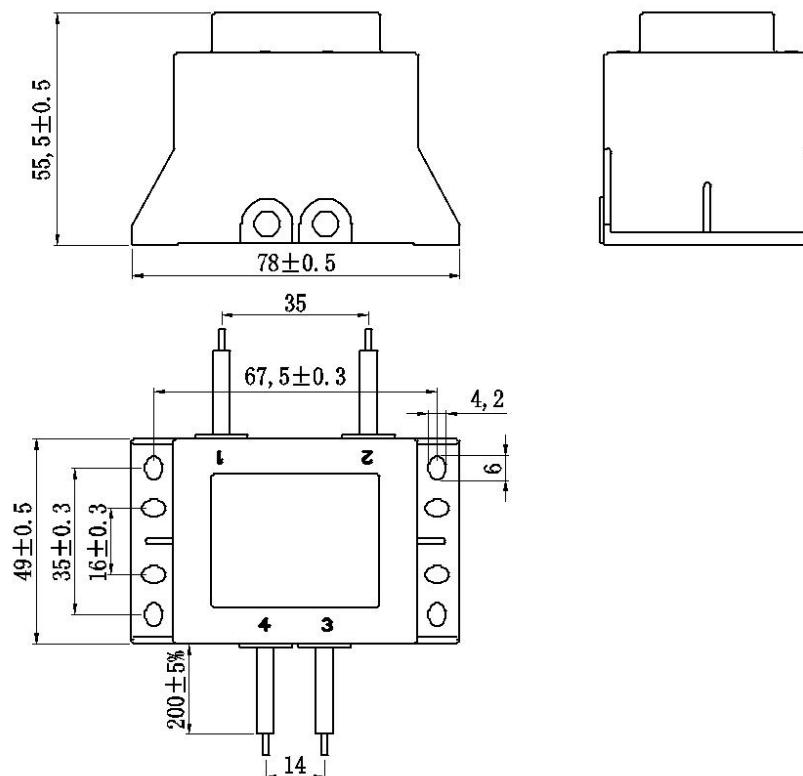

9. Existing model parameter

1. SG3505-01

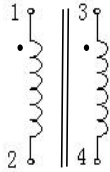

Input Feature	Pins	Input voltage	Idle Current	Output Power	Pin Layout
	A-B	220V/50/60Hz	$\leq 20\text{mA}$	5VA	Fig 2
Output Feature	Pins	Idle Voltage			
	7-9	12.5V			
Safety Feature	Primary to secondary				
	$\geq 25\text{kV}/60\text{s}$				

This series of products are customized. Other parameters can be designed according to customer requirements.