

User Manual

Exterior Garden Spike Spot Lighting

Please read user manual before commencing installation and keep it for future reference.

■WARNING.



Attention! Dangerous electrical voltage.
Possible consequences: Death or severe injury.

1. The safety of this lighting fixture is guaranteed only if you comply with these instructions.
2. Please use the specific input voltage.
3. Please disconnect the power before repair, installation or replacement.
4. Please use the lights in the proper application places as to avoid the lights be broken.
5. Do not locate fixtures in low areas where water will collect.
6. If any questions on this instruction, please consult a professional qualified technicians.

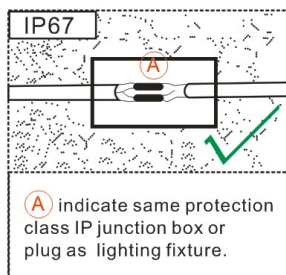
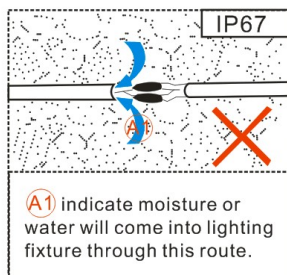

■Instructions of installation.

1. Ensure mains supply is switched off.
2. Unpack the packaging carefully.

---Spike installation

3. Select a suitable location for your spotlight.
4. Insert the ground stake into the soil.

Note: If the ground is hard or installation is difficult, thoroughly wet the ground where you wish to install the spike using a garden hose or watering can.

5. Carefully assemble the light bracket section on the ground stake with the provided screws.
7. Adjust the tilt of the light for a suitable direction for your application.
8. Connect the cable to the mains supply with the IP67/IP68 high quality waterproof connectors.
9. Ensure everything is installed very well, and then turn on the power for the illumination application.

Note: The power of main supply must be switched off. before connecting the cables.

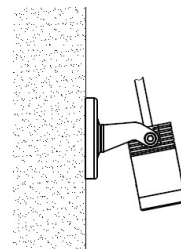
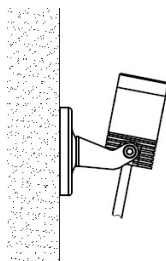
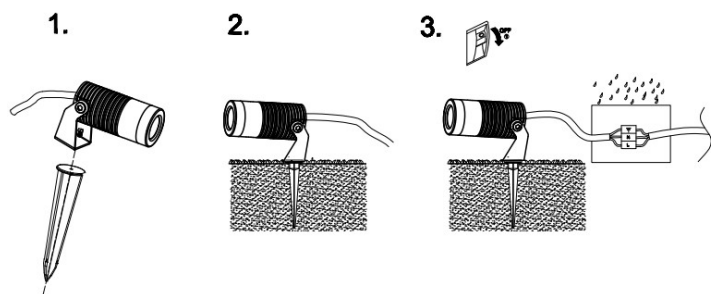

---- With the round base for wall installation

3. Drill three screw holes as the drawing with cut out 6mm.
4. Fix the round base on the wall with the provided screws as drawing
5. Adjust the tilt of the light for a suitable direction for your application.

6. Connect the cable to the mains supply with the IP67/IP68 high quality waterproof connectors.
 7. Ensure everything is installed very well, and then turn on the power for the illumination application.
- Note: The power of main supply must be switched off. before connecting the cables.

---Tree Belt installation

3. Select a suitable location and Suitable height on tree for your spotlight.
4. Fix the lighting fixture onto the stainless steel fixed part of the belt.
5. Mount the nylon belt strap with the lamp onto the tree.
6. Secure and tighten the strap by using the ratchet.

Note: Annual inspection of the strap is required to ensure the fixture is secured because the tree is growing. If failed to do this, severe failure may happen and fixture may fail off from the tree.

7. Adjust the tilt of the light for a suitable direction for your application.
 8. Connect the cable to the mains supply with the IP67/IP68 high quality waterproof connectors.
 9. Ensure everything is installed very well, and then turn on the power for the illumination application.
- Note: The power of main supply must be switched off. before connecting the cables.

1.



2.

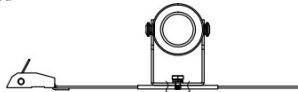

3.

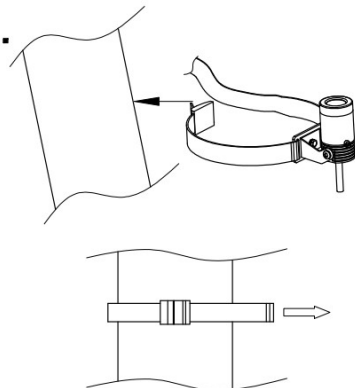

4.

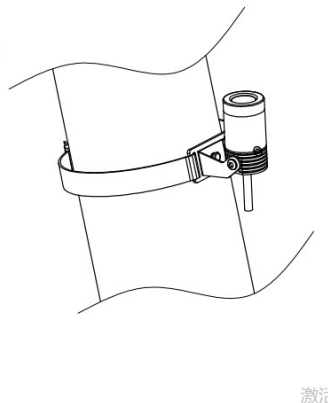

■Specifications.

Input: AC100-245V

IP rating: IP67

Class: I



Warning.

The non-professionals can not disassemble or repair the fixture. We keep the right to refuse the replacement or repairing of the fixtures that have been disassembled or repaired personally.