

PROJECT PRODUCTS

Metal Ceiling Panel

Advantages

The Clip-in ceiling system offers a seamless aesthetic and effortless installation, achieved through a unique clipping mechanism that securely attaches panels to the framework. This design ensures a clean and consistent ceiling surface, favored in commercial settings.

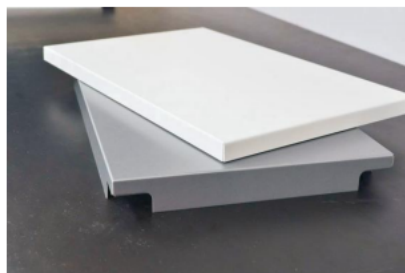

Application

Airport, Transport Station, Shopping mall, Conference, exhibition center, hotel, stadium, hospital, school, office

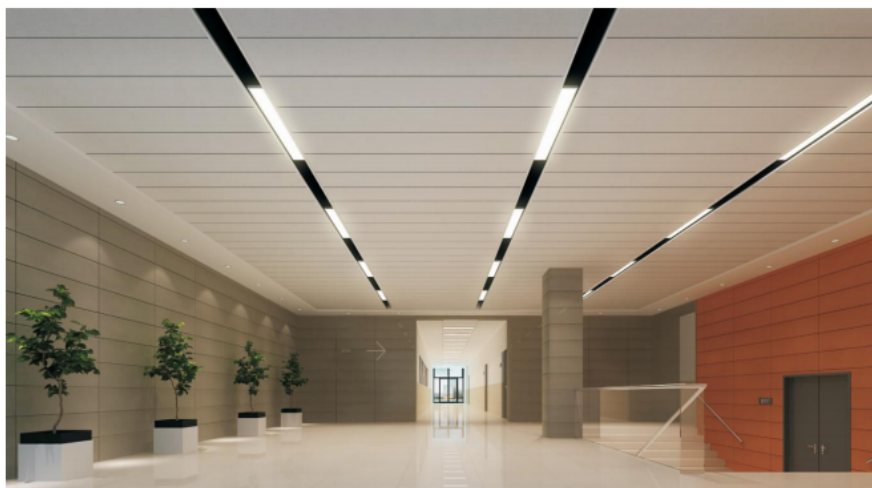

Installation Node Diagram

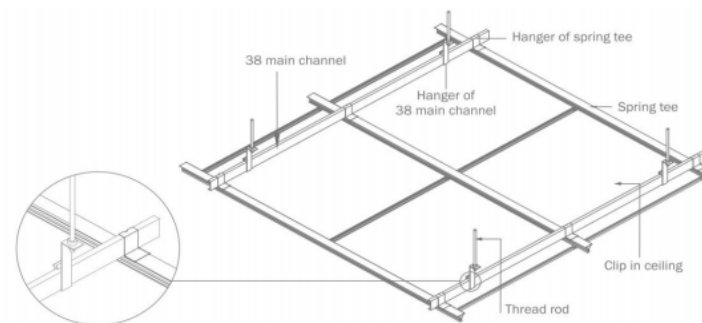

General Parameters

300mm×300mm、300×450mm、300×600mm
600×600mm、800×800mm、300×1200mm、600×1200mm