

Custom tension link load cell

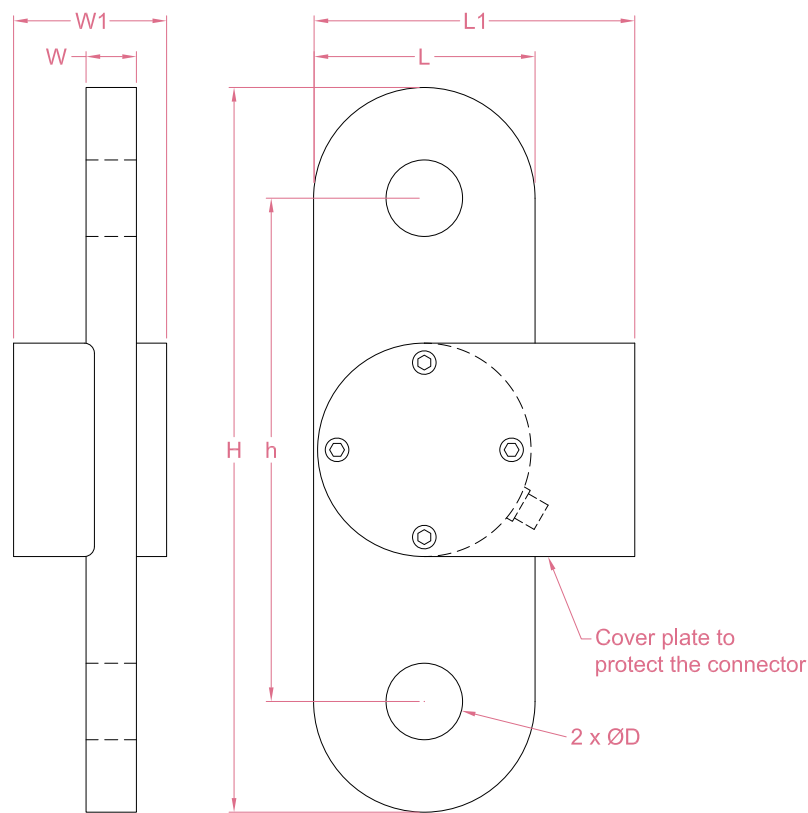

Capacity (Up to 500 ton)		Quantity	
L		L1	
W		W1	
H		h	
D		/	
Working Temp. (-40...+150°C)		Ingress protection (Up to IP68)	
Power supply		Output signal	
Material		Surface treatment	
Other requirements			

Please fill in the form above and send an email to sales@loadcellsensor.com for feasibility assessment and quotation.