



Size:80\*80\*20mm

### General Specifications:

Motor: 4 pole brushless DC motor  
 Frame: Thermoplastic PBT+30%GF  
 Impeller: Thermoplastic PBT+15%GF  
 Bearing: Precision Ball Bearing/Sleeve Bearing  
 Storage temperature: -40°C to +75°C  
 Operating temperature:-10°C to +70°C



### Major Characteristic Parameters



MODEL	Bearing System	Rated Voltage (V)	Rated Current (A)	Input Power (W)	Speed (RPM)	Max Air Flow (CFM)	Max Static Pressure (mm H2O)	Noise (dBA)	Weight (g)
FD1280207S(B)	S/B	12	0.25	3.00	3500	36.37	3.84	34.0	75
FD1280205S(B)	S/B	12	0.18	2.16	3000	31.53	3.03	31.0	75
FD1280203S(B)	S/B	12	0.12	1.44	2500	25.87	2.17	27.0	75
FD1280201S(B)	S/B	12	0.08	0.96	2000	20.42	1.42	22.0	75
FD2480207S(B)	S/B	24	0.15	3.60	3500	36.37	3.84	34.0	75
FD2480205S(B)	S/B	24	0.10	2.40	3000	31.53	3.03	31.0	75
FD2480203S(B)	S/B	24	0.08	1.92	2500	25.87	2.17	27.0	75
FD2480201S(B)	S/B	24	0.06	1.44	2000	20.42	1.42	22.0	75

\* B: Two Ball bearing S: Sleeve Bearing \* All reading are typical values at rated voltage  
 \* Function type optional \* Specifications are subject to change without notice

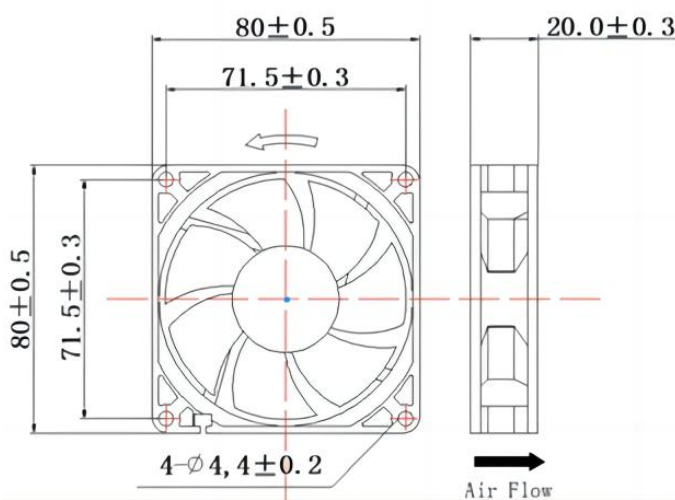

### Characteristic Curve

