



Fiber PoE Switch

➤ User Manual

S500P-1F-1FX



hasivo, Sichuan

1 Overview

The S500P-1F-1FX Unmanaged Fiber PoE Switch adopts the standard international scheme, which can automatically detect and supply power to the receiving equipment conforming to the IEEE802.3af/at PoE++/HiPoE standard. The standard international scheme is adopted, and the fiber optic cable is used as the transmission medium, with fast speed, long distance and strong anti-interference ability. Its built-in integrated optical port transmission distance is up to 20KM. The use of this equipment can facilitate the layout of enterprise engineering long-distance projects, realize centralized network management, and reduce the failure rate of equipment and network.

Features

- ◆ Fiber module transmission distance:MAX 3KM/20KM(optional)
- ◆ Fiber module :optional single mode single fiber/double fiber(FC customizable)
- ◆ PoE Standard:IEEE 802.3af/at HiPoE PoE++ ,support all ports standard detection.
- ◆ Support power supply for PoE equipments such as AP and network monitoring camera connected by Cat5/6 ethernet cables.
- ◆ Flow control method:full duplex adapts IEEE802.3, halfduplex adapts Back pressure.
- ◆ Port supports Auto MDI/MDIX.
- ◆ Single port PoE power:30W(optional first port power:60W) .
- ◆ Exchanging Mechanism:store and forward.
- ◆ Zero-configuration:automatically supply for adaptive equipments.
- ◆ Panel indicator monitors operating status and helps fault analysis.

2 Product Display

S500P-1F-1FX,1*10/100M PoE + 1*100M Integrated SFP

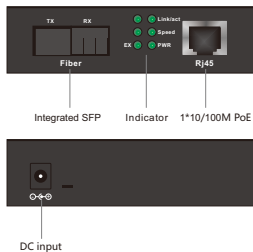

Indicator definition

Front indicator	state	Description
Power indicator: PWR	on	Power on
	off	Power off
SFP indicator: EX	on	Corresponding optical port signal connection
	off	The corresponding optical port signal is not connected
Network indicator:Link/act	on	Link on
	off	Link off
Speed indicator: Speed	on	There is power receiving equipment connected with it and normal power supply
	off	No receiving equipment is connected with it or there is no power supply

Product matching list

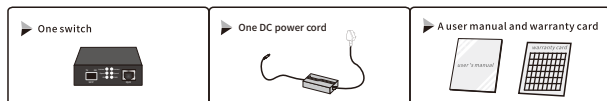

⚠ **PS:**SFP models do not include optical modules by default. If you find any shortage or damage of accessories, please contact us in time

Installation Guide

For the safe installation operation of switch,suggestion:

- Check up that the power wire is securely wrapped into the AC power connecto
- or not.
- Ensure the adequate heat dissipation and ventilation around the switch.

DESK

An installation of switch on the desktop, The rubber foot pads must be installed on the bottom of four corners of switch to ensure enough space between equipment and surrounding objects for



Power supply socket specification

Switch power line single-phase three wire power socket, the middle foot to ground,The left foot on the right foot for the zero line and FireWire, please check before the operation.

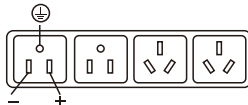

1.2.1

Connect the power cord

1. Check up that the power supply is consistent with the marked requirements by the switch or not;
2. The external type requires a power adapter, which can be directly connected to the 52V 0.6A mains supply; As shown in Figure 1.2.2.

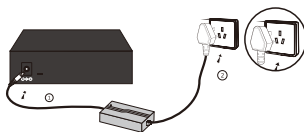

1.2.2

Inspection after installation

Please check the following items after installation:

1. check whether there is enough space for heat exchange, air circulation is smooth;
2. check the power supply socket power supply switch is in accordance with the specifications;
3. check the power supply, switchboard, rack and other equipment have been properly grounded;

4 Application

Multiplexing application

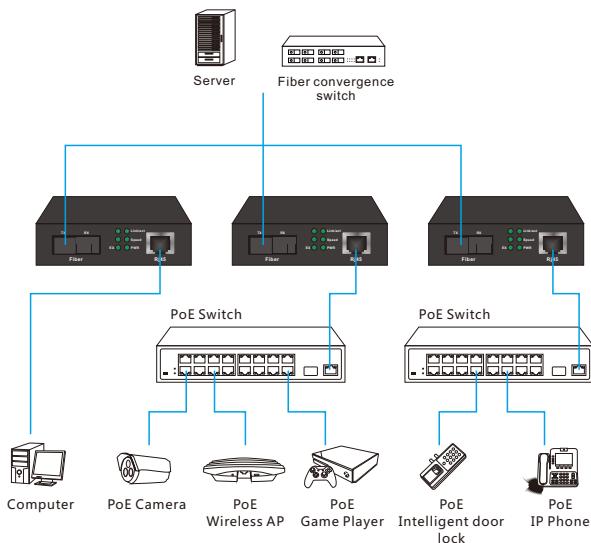

Fiber to fiber application

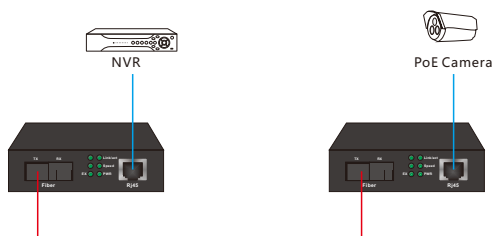

5 Parameter

Model	S500P-1F-1FX
Product name	Fast Ethernet 1+1 Fiber PoE Switch
Fixed Port	1*10/100Base-TX PoE port (data/power) 1*100M Integrated SFP (optional 1310/1550)
PoE Ports	1 port supports PoE(optional first port outputs HiPoE_60W)
PoE Pin	Default 1/2(+), 3/6(-); Optional order 4/5(+), 7/8(-)
Network Protocol	IEEE802.3 IEEE802.3i 10BASE-T IEEE802.3u 100BASE-TX IEEE802.3x IEEE 802.3z 100BASE-X IEEE802.3af/at(optional order HiPoE PoE++)
Port Specification	10/100BaseT (X) Auto
Transmission Mode	Store and Forward(full wirespeed)
Bandwidth	1Gbps
Packet Forwarding	0.72Mpps
MAC	1K
Buffer	768K
Transmission Distance	10BASE-T : Cat3,4,5 UTP(≤250 meter) 100BASE-TX : Cat5 or later UTP(150 meter) Single mode single fiber(MAX 20KM) Single mode double fiber(MAX 20KM) Multiple mode double fiber(MAX 850meter/2KM) Optional 3~80KM SFP
Single port power	Average 15.4W;MAX 30W
Total power/ Input voltage	MAX 30W (52V 0.6A)
Watt	Standby Power Consumption : ≤1.5W ;
LED Indicator	PWR: Power LED EX:(Fiber optic signal LED) Link/act:(Network signal LED) Speed:(Extension indicator)
Power Input	External power DC : 52V 0.6A
Operating Temperature /Humidity	-10 ~ +55°C ; 5% ~ 90% RH Non coagulation
Storage Temperature /Humidity	-40 ~ +75°C ; 5% ~ 95% RH Non coagulation
Product /Packing size (L*W*H)	93mm*69mm*25mm 205mm*135mm*95mm
N.W/G.W (kg)	0.1kg/0.7kg
Installation	Desktop
Lightning Protection level	6KV 8/20us ; IP30
Certificate	3C ; CE-EMC EN55032 ; CE-LVD EN62368 ; FCC Part 15 Class B ; RoHS ;
Warranty	Whole device for 1 year(Accessories not included)

Matters needing attention

To avoid equipment damage and personal injury caused by improper use, please follow the following precautions:

- During installation, keep the power off, wear anti-static wrist, and ensure that the anti-static wrist is in good contact with the skin to avoid potential damage. Potential safety hazards in;
- The switch can work normally only under the correct power supply. Please confirm that the power supply voltage is consistent with the voltage marked by the switch;
- Before the switch is powered on, please make sure that the power circuit will not be overloaded, so as not to affect the normal operation of the switch or even cause unnecessary damage;
- In order to avoid the risk of electric shock, do not open the shell when the switch is working, and do not open it by yourself even when it is not charged;
- Before cleaning the switch, pull out the power plug of the switch. Do not wipe it with wet fabric or clean it with liquid;
- The equipment installed in the rack is generally from bottom to top to avoid overload installation;
- Avoid placing other heavy objects on the surface of the switch to avoid accidents.

PS: We will try our best to check the errors in the printing and pictures, but hasivo will not be responsible for any possible omissions. The appearance, specifications, parameters, prices and supply conditions of the products listed on this page are subject to change without notice.