

Manufacturer			SINOLIFT	
Model			T20	T20i
Operator Type			Walkie	Walkie
Drive			Eelectric/Manual	Eelectric/Manual
Lift			Manual	Electric/Manual
Load Capacity	Q	kg(lbs)	2000 (4000)	2000 (4000)
Load Center	C	mm(inch)	600 (24")	600 (24")
Wheelbase	Y	mm(inch)	1202(47.3")/1272 (50.1")	1202(47.3")/1272 (50.1")
Service Weight		kg(lbs)	106(232)/110(242)	116(255)/118(260)
Overall Height	h1	kg(lbs)	522.5(20.6")	587(23.1")
Fork Height (Lowerd)	h2	mm(inch)	80(3.15")	80(3.15")
Lift Height	h3	mm(inch)	200(8")	200(8")
Tiller Arm Height	h4	mm(inch)	560(22") - 1280(50.4")	560(22") - 1280(50.4")
Min. Ground Clearance	h5	mm(inch)	27(1.1")	27(1.1")
Overall Length	L1	mm(inch)	1546(60.8")/1616(63.6")	1546(60.8")/1616(63.6")
Overall Width	b1	mm(inch)	540 (21")/680(27")	540 (21")/680(27")
Fork Size(Length)	L	mm(inch)	1150(45")/1220(48")	1150(45")/1220(48")
Fork Size(Thickness)	s	mm(inch)	53(2.1")	53(2.1")
Fork Size(Width)	e	mm(inch)	160(6.3")	160(6.3")
Turning Radius	Wa	mm(inch)	1352(53.2")/1422(56")	1352(53.2")/1422(56")
Aisle Width for Pallet 1000x1200 crossway	AST	mm(inch)	1980(78")	1980(78")
Aisle Width for Pallet 800x1200 crossway	AST	mm(inch)	1880(74")	1880(74")
Drive Motor		kw	0.75kw brushless	0.75kw brushless
Travel Speed (Laden/Unladen)		km/h(mph)	4.2(2.6)/4.5(2.8)	4.2(2.6)/4.5(2.8)
Max. Gradeability (Laden/Unladen)	%		8/20	8/20
Brake Service			Electromagnetic	Electromagnetic
Lift Motor		kw	N/A	0.65kw
Controller			Sinolift i50	Sinolift i50
Battery Voltage/Capacity	V/Ah		48/10 Li-Ion Battery	48/15 Li-Ion Battery
Charger	V/A		48/5	48/5

1.The parameters in the table are of the standard model. For more infomation, please contact us.

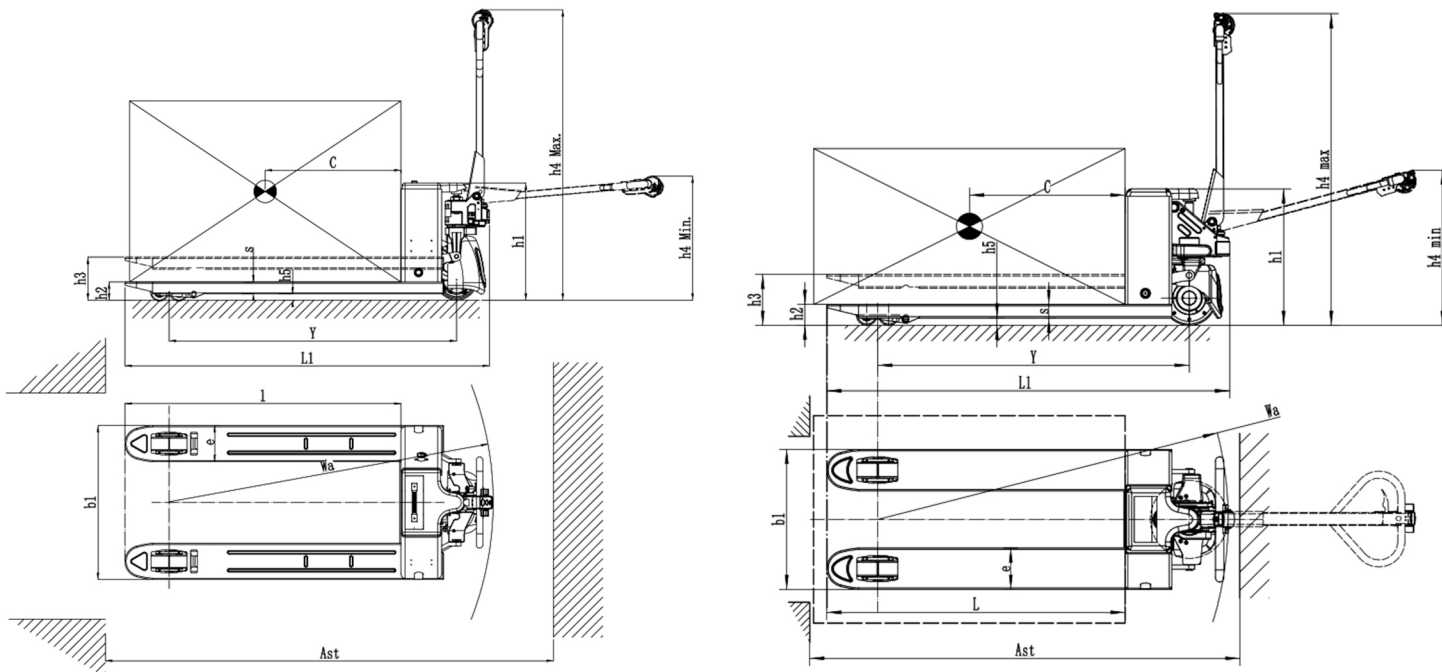

( T20 )

( T20i )

Special size of width and length can be made according to customer's requirement. All specifications and figures are subject to change without notice for improvement.



*Easy Lift, Easy Life!*

**1500/2000/3000KG LOAD CAPACITY**  
**3300/4400/6600LBS LOAD CAPACITY**

Electric/Manual mode switch features NO DOWNTIME, Aim to 4 million huge HPT market, the intelligent warehouse work partner.

- Compact design
- Quick-charging battery
- High-productivity tiller
- Easy-entry forks
- Choice of load capacities
- Integrated rocker arm
- Universal battery exchange
- Digital battery discharge + hour meter



**SHANGHAI SINOLIFT MECHANICAL AND ELECTRICAL EQUIPMENT CO., LTD.**

ADDRESS: No. 2471 Dachuan Road, Nanhui Industry Park, Pudong New District, Shanghai, 201399,P.R.China

Tel: 0086-21-68014500 or 0086-21-58003681

Fax: 0086-21-68014262

Website: [www.sinolift.com](http://www.sinolift.com) [www.sinoliftchina.com](http://www.sinoliftchina.com) [www.sinolifttruck.com](http://www.sinolifttruck.com)

Skype: sinolift

Whatsapp & Mobile: 0086 138 1757 2420



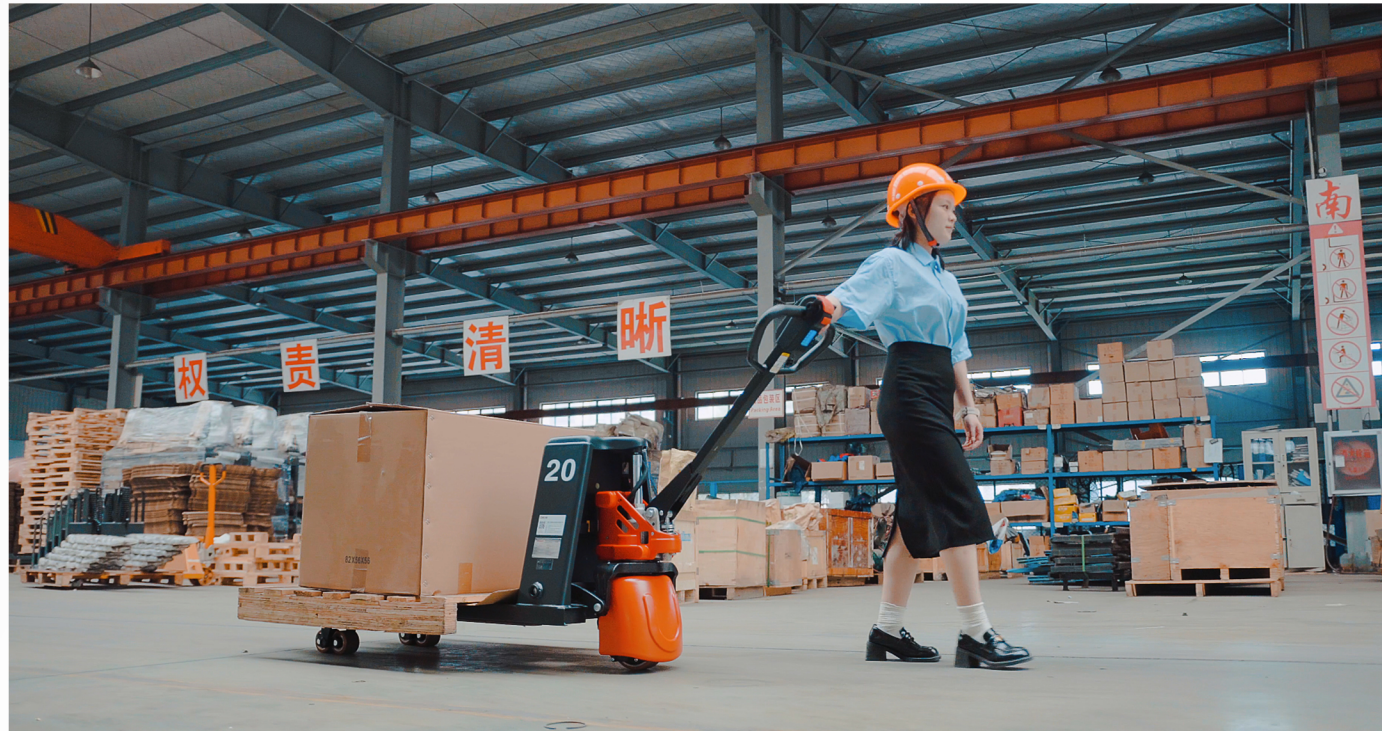

The T20/T20i hybrid electric pallet truck is a powerful and reliable machine for lifting and transporting goods. Its use allows you to streamline pallet handling and improve material flow in your facility. This pallet truck is designed to meet the highest standards of safety and quality. This innovative pallet jack brings you many benefits. One of the main advantages is that it is hybrid. Its travel and stroke can operate in both electric mode and manual mode. Another advantage is the brushless motor, which allows for easy maintenance. It also features a powerful lithium battery (16 Ah lithium battery equivalent to a 25.6 Ah AGM battery) that can last up to 2000 cycles when used properly. It is also equipped with an I-TOUCH handle to give you the best IOT (Internet of Things) experience.

## Electric Pallet Truck

### EASY TO USE

One of the biggest advantages of the T20i electric truck is its ease of use. Thanks to the electric drive and intuitive control system, you can lift and transport pallets with minimal effort. The palletiser is equipped with a powerful electric motor that enables smooth and quiet movement. This means that you can easily operate the truck in your facility regardless of the noise level.

The I-TOUCH handle makes handling the trolley much easier. You can set your own password to prevent unauthorised use of the trolley. You can also see how long the trolley has been working, how far it has travelled, whether it is time to charge the battery, what speed it is travelling at, how much the load weighs, etc.

### SAFETY

Safety is our priority. Our T20i trucks are equipped with safety features such as emergency brakes and protection systems to minimize the risk of accidents and injuries. So you can concentrate fully on your work without having to worry about your safety.

### SAVING TIME AND ENERGY

Thanks to the electric drive, this trolley allows you to move loads quickly and efficiently. You don't have to deal with manual movement or the loss of energy when manually moving or lifting. With our trolleys, you can complete your job faster and more efficiently. The trolley is also capable of weighing while moving the goods, so you can control the weight of the goods being unloaded/loaded.

The T20i electric pallet trucks are designed to provide simple and intuitive operation. You will feel comfortable and confident with our trolleys, even when handling in tight spaces. They are equipped with a slow "turtle" speed.

### HIGH CAPACITY

Thanks to its sturdy construction and solid forks, it is able to easily handle pallets of different weights. The trolley is also equipped with a precision lifting mechanism, which enables accurate and safe lifting of pallets. With its help, you can easily and accurately position pallets in the warehouse or move them to the truck for transport.

### FLEXIBILITY AND VERSATILITY

Thanks to its design, the T20i Hybrid Electric Starter can easily adapt to different environments and conditions. It is able to operate in a temperature range from 5°C to 40°C, making it ideal for most workplaces. A great advantage is that the trolley can be switched from electric to manual mode and can be used continuously and, most importantly, flexibly.

### ENVIRONMENTALLY FRIENDLY

The T20i electric pallet truck is the environmentally friendly choice because it produces no emissions and requires no fuel. It helps reduce your carbon footprint and contributes to the sustainable development of your business.

Are you looking for a partner to handle your light duty work? T20i is the perfect solution! Our I-TOUCH handle provides an unparalleled Internet of Things experience, making it effortless to control and monitor tasks. Equipped with an AC Brushless Motor – both manual and electric convertible – this innovative product guarantees zero downtime. With our Sinolift technology, you can look forward to a more efficient future. Don't settle for anything less – choose T20i to ensure the best results!

- Electric Lifting Mode, easy and efficient**
- Manual Lifting Mode, extending 30 minutes of working time NO DOWNTIME**
- Brushless motor, Higher efficiency and performance, Free Maintenance**
- Hybrid Pump**
- Hybrid Driving**
- Patented Clutch Technology, Electric/Manual convertible NO DOWNTIME**
- I-Touch Screen**
- 2.5 inch screen, High Resolution, Smart Touch**
- Li-Ion Battery**
- 48V15Ah big capacity, portable, 2-3 hrs quick charge, 2000 cycles with 80% residual capacity Bigger capacity battery available.**
- Reinforced Fork**
- Super robust structure, Full loop enhancement**

# SMART I-TOUCH

PASSWORD		<p><b>Set your own PASSWORD</b> trained &amp; qualified personnel / unqualified personnel x <b>SAFETY secured!</b> (can be switched off)</p>	TIME	1	Hr	<p>The <b>Time</b> past The <b>Road</b> travelled The <b>Sweat</b> flowed The <b>speed</b> chosen The <b>Load</b> carried How is the Truck Status?</p>	VNA MODE	ON	VNA MODE ON/OFF		
CODE	*****		TRIP	1.625	km		PASSWORD	ON	PASSWORD ON/OFF		
1	2		3	BATTERY	25.6		%	SLOPE	8	%	TEST THE SLOPE
4	5		6	SPEED	5		km/h	MAX.SPEED	3	km/h	ADJUST THE SPEED
7	8		9	WEIGH	0		Kg	FAULTCODE	1502		WHERE GOES WRONG?
CLEAR	0		MODIFY	SETUP			MORE INFO			FAULT CODE TELLS YOU!	
OK						HOMEPAGE			EASY MAINTENANCE		