



MKP-AT (AC-Filter)



■ 特性 Features

安装简单方便

容量大、体积小

耐高压，具有自愈性

高纹波电路，高 dv/dt 承受力

Easy mounting;

Large capacity, compact size;

High withstanding voltage capability self-healing property;

High ripple current capability, high dv/dt strength



■ 应用 APPLICATION

广泛用于电力电子电路中做交流滤波用；治理谐波及提高功率因数

Widely used in power electronic circuits for AC-Filtering; Harmonic control and power factor improvement.

■ 性能参数 Technical data

项目 Item	性能 Performance Characteristics	
使用温度范围 Operating Temperature range	-40 +105℃	
贮存温度范围 Storage Temperature range	-40 +105℃	
额定电压 Rated Voltage Range	450 ~ 1140V.AC	
额定容量 Rated Capacity	5~50 μ F	
静电容量范围 Capacitance Tolerance	± 5% (J) / ±10% (K)	
介质损耗 (tan δ) Dissipation Factor (tan δ)	≤0.0015 at 20°C, 1K Hz	
耐电压 Voltage Proof	极间V _{tt}	1.5Un(10S,20°C ± 5°C)
	极壳V _{t-c}	---
杂散电感 ESL	≤30nH	
绝缘电阻 IR	≥5000s at 100VDC/60S	
耐久性试验 Endurance	测试条件：温度 85℃ ± 3℃；施加额定电压Un；试验时间 1000h.	
	静电容量变化 Capacitance change	ΔC/C0 ≤10%
	损耗角正切 D.F. (Tan δ)	Δtanδ ≤ 1.2tanδ + 0.0001
预期寿命 Life	100000h (可参考寿命曲线图)	



MKP-AT (AC-Filter)

尺寸图 Dimension

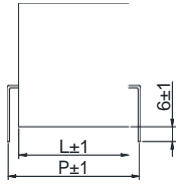

Syle: A

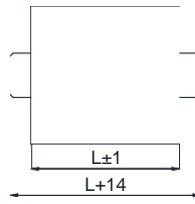
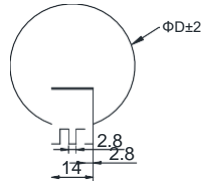

Syle: B

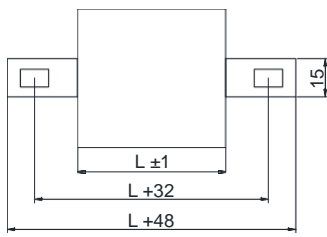
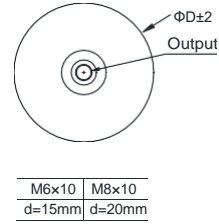

Syle: C

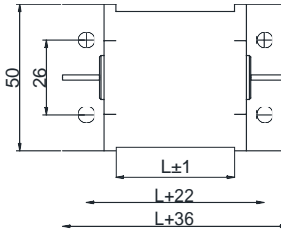
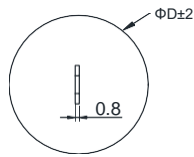

Syle: D

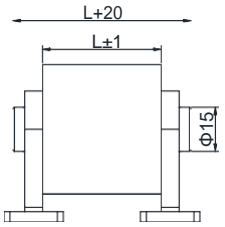
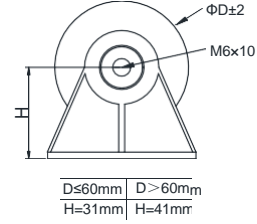

Syle: E

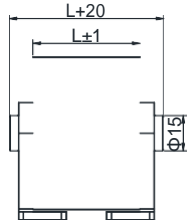
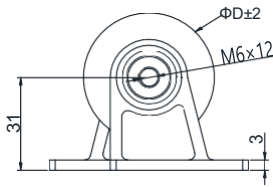

Syle: F

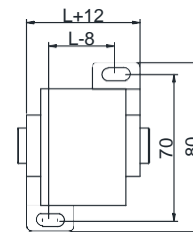
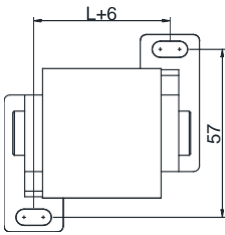
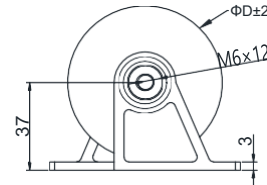

Cap (μF)	Dimension (mm)			I _{rms} @25°C (A)	ESR @ 1KHz 1V (mΩ)	dv/dt (V/μs)	I Peak (A)	Part Number
	φD	L	P					
Un 450V.AC								
6.8	34	60	72	15	9	100	680	190685J450A—
8	37	60	72	15	8.5	100	800	190805J450A—
10	41	60	72	18	8	100	1000	190106J450A—
15	50	60	72	22	6	100	1500	190156J450A—
20	57	60	72	25	5	100	2000	190206J450A—
30	70	60	72	30	4	100	3000	190306J450A—
Un 690V.AC								
5	35	60	72	15	11	120	600	190505J690A—
6.8	40	60	72	16	9	120	816	190685J690A—
8	44	60	72	18	8.5	120	960	190805J690A—
10	49	60	72	20	8	120	1200	190106J690A—
15	59	60	72	25	6	120	1800	190156J690A—
20	68	60	72	30	5	120	2400	190206J690A—