

GT11 Series

Ultrathin Laptop Keyboard Switch-2.5mm Travel



■ Features

- ◆ With tactile sound or smooth mute for selection
- ◆ Feel smooth and natural
- ◆ Service life can reach more than 10 million times
- ◆ Can be equipped with RGB-LED lights to add colorful backlight
- ◆ Patent products, the world's first

■ Applications

- ◆ Notebook computer keyboards

■ Specification and Parameters

Electical Characteristics	Rating	12V DC/AC Max. 10mAAC/DC Max
	Initial Contact Resistance	200mΩ Max
	Insulating Resistance	100MΩ Min
	Voltage Resistance	AC 100V (50-60Hz) 1 Min
	Electrical Life	Over 10,000,000 cycles (Load)
	Bounce Time	Operation speed at<400mm/sec
Parameters	Tactile Force (TF)	70±15gf
	Tactile Position (TP)	1.0±0.3
	Operating Position (OP)	(TP±0.1) ≤OP≤1.2mm
	Total Travel (TT)	2.5±0.2mm (GT11A) 2.5+0/-0.3mm (GT11B)
	Return Force (RF)	RF=20gf Min
	Mechanical Life	Over 20,000,000 cycles (NO Load)
	Operating Temperature	-40°C~+80°C
	Operating Humidity	≤85% RH
	Hand Soldering Condition	3Sec Max. 360°C±10°C

■ Travel-Force Curve

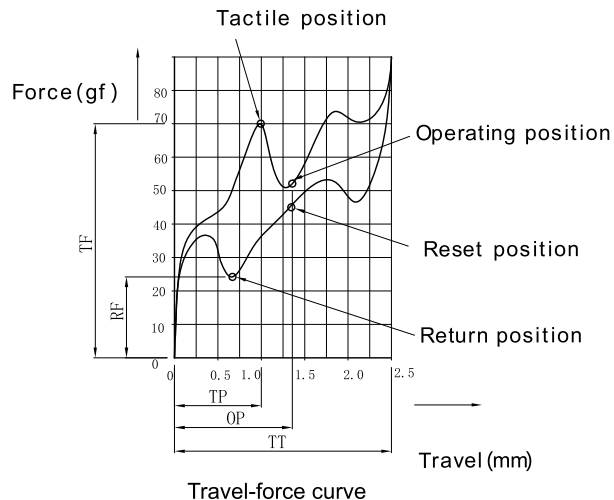

GT11 Series Keyswitch Ordering Instruction

GT11	A	1	C	N	P	T001	U
Unionwell Switch Type	Keyswitch Height	Code of Operating Force	Operating Characteristics and Key Style	LED Diode	Mounting Options	Custom Code	LOGO
A	A 6.7mm	1 OF=70±15gf	Single pole, standard type, black key	N No LED, No Diode	P With pins	General	U Unionwell
B	6.4mm	2 Other to be defined	Single pole, tactile feel, white, sound translucent key		S Suitable	Customized according to requirements, the code format is T+ serial number XXX for example:T001	... Other
C	Other					... Other	

■ Dimensions

(Unit:mm)



H=6.7mm(DIP)

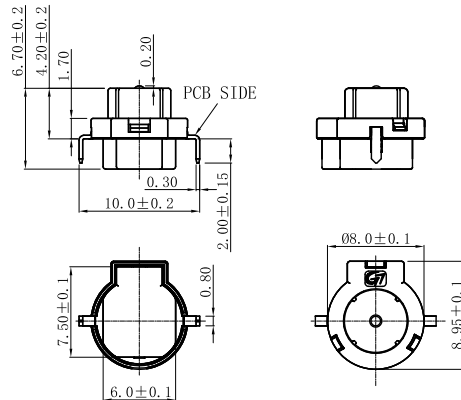

H=6.4mm(DIP)

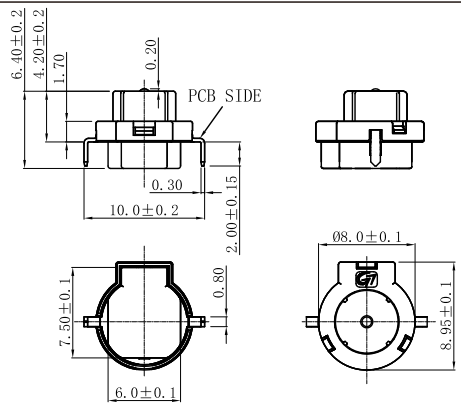

■ Circuit Board Layouts

